

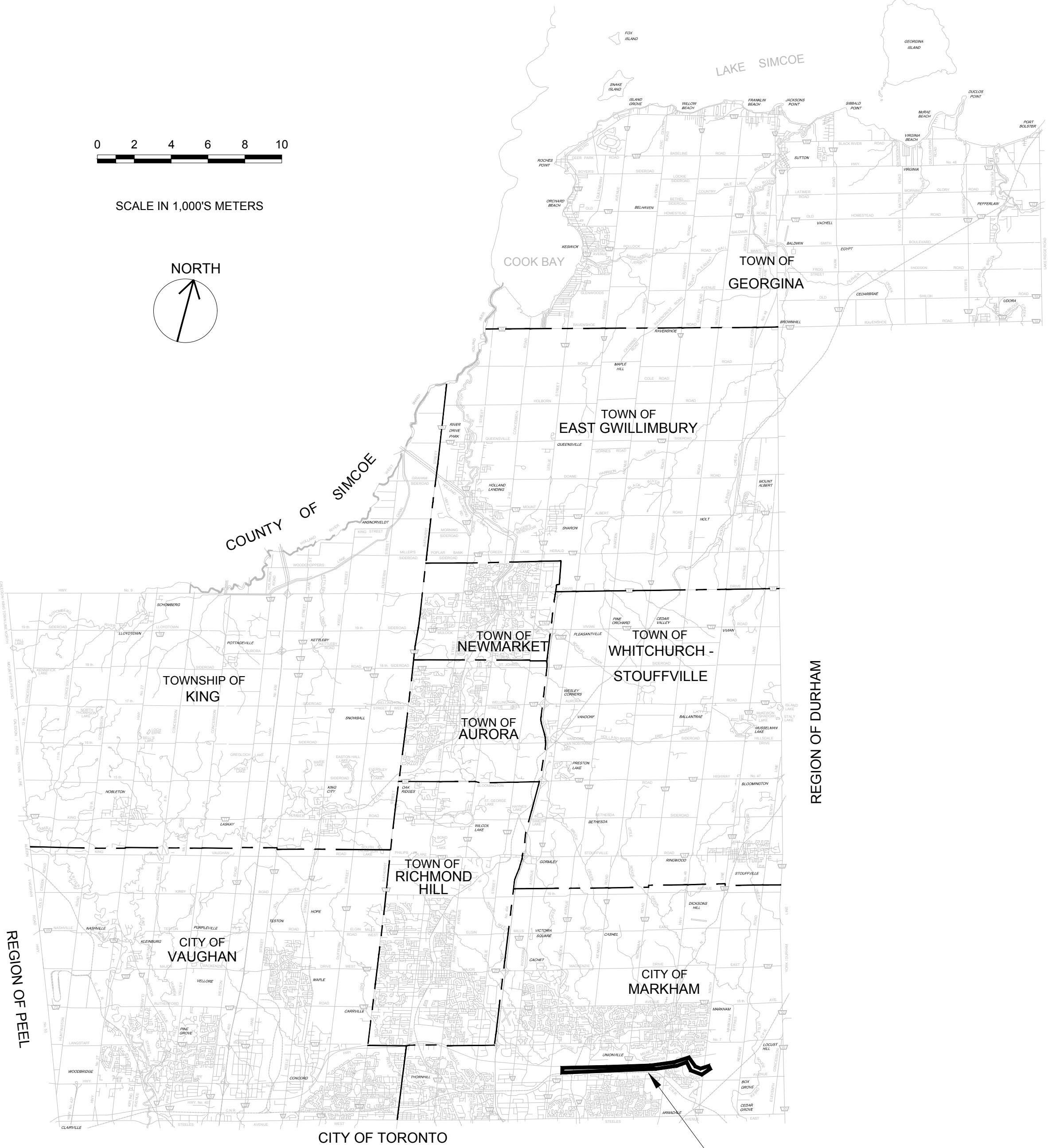

Public Works - Environmental Services

CLIENT'S REFERENCE NO. 75320-EI18301
MARKHAM COLLECTOR TWINNING (Y2)
CONCEPTUAL DESIGN



CONTRACT SITE

W. EMMERSON
REGIONAL CHAIR

E. MAHONEY
COMMISSIONER OF PUBLIC WORKS

ISSUED FOR CONCEPTUAL DESIGN
AUGUST 2023



File Location: C:\Users\jacob1\OneDrive - Jacobs\OneDrive - Jacobs\Projects\75320-EI18301\Conceptual Design\Map\IN\Sheet\Y2-COVER.dwg Last Saved: August 1, 2023, by CA073912 Printed: August 1, 2023

DRAWING INDEX

| GENERAL | DWG. No. | DRAWING DESCRIPTION |
|---------|--------------|---------------------|
| 1 | Y2 - COVER | COVER SHEET |
| 2 | Y2 - INDEX | DRAWING INDEX |
| 3 | Y2 - DWGLIST | DRAWING LIST |

PLAN AND PROFILE

| SHEET NO. | DRAWING NUMBER | DRAWING DESCRIPTION |
|-----------|----------------|-------------------------------------------|
| 1 | Y2-C1 | PLAN AND PROFILE - STA 0+000 TO STA 0+700 |
| 2 | Y2-C2 | PLAN AND PROFILE - STA 0+700 TO STA 1+400 |
| 3 | Y2-C3 | PLAN AND PROFILE - STA 1+400 TO STA 2+100 |
| 4 | Y2-C4 | PLAN AND PROFILE - STA 2+100 TO STA 2+800 |
| 5 | Y2-C5 | PLAN AND PROFILE - STA 2+800 TO STA 3+500 |
| 6 | Y2-C6 | PLAN AND PROFILE - STA 3+500 TO STA 4+200 |
| 7 | Y2-C7 | PLAN AND PROFILE - STA 4+200 TO STA 4+900 |
| 8 | Y2-C8 | PLAN AND PROFILE - STA 4+900 TO STA 5+600 |
| 9 | Y2-C9 | PLAN AND PROFILE - STA 5+600 TO STA 6+300 |
| 10 | Y2-C10 | PLAN AND PROFILE - STA 6+300 TO STA 7+000 |
| 11 | Y2-C11 | PLAN AND PROFILE - STA 7+000 TO STA 7+700 |
| 12 | Y2-C12 | PLAN AND PROFILE - STA 7+700 TO STA 8+400 |
| 13 | Y2-C13 | PLAN AND PROFILE - STA 8+400 TO STA 9+100 |
| 14 | Y2-C14 | PLAN AND PROFILE - STA 9+100 TO STA 9+500 |

File Location: C:\Users\ca73912\OneDrive - Jacobs\Y2-Conceptual Drawings\WPMUN\Sheets\Y2-DWGLIST.dwg Last Saved: August 1, 2023, by CA073912 Plotted: August 1, 2023

THE LOCATION OF UTILITIES IS APPROXIMATE ONLY, AND THE EXACT LOCATION SHOULD BE DETERMINED BY CONSULTING THE MUNICIPAL AUTHORITIES AND UTILITY COMPANIES CONCERNED. THE CONTRACTOR SHALL PROVE THE LOCATION OF UTILITIES AND SHALL BE RESPONSIBLE FOR ADEQUATE PROTECTION FROM DAMAGE DURING CONSTRUCTION.



SEAL

| No. | DATE | REVISIONS | BY |
|-----|----------|------------------------------|----|
| 0 | AUG 2023 | ISSUED FOR CONCEPTUAL DESIGN | CA |



Regional Municipality of York

| |
|-------------------|
| DATE AUG. 2023 |
| DESIGN IH |
| DRAWN CA |
| CHECKED PP/DB |

**YORK REGION SEWAGE WORKS PROJECT
MARKHAM COLLECTOR TWINNING (Y2)
CONCEPTUAL DRAWINGS
DRAWING LIST**

| |
|----------------------------------|
| SCALE NTS |
| DWG. NO. Y2-DWGLIST |
| CLIENT REF. NO. 75320-EI18031 |
| SHEET NO. |

SCALE CHECK 1 in 10mm

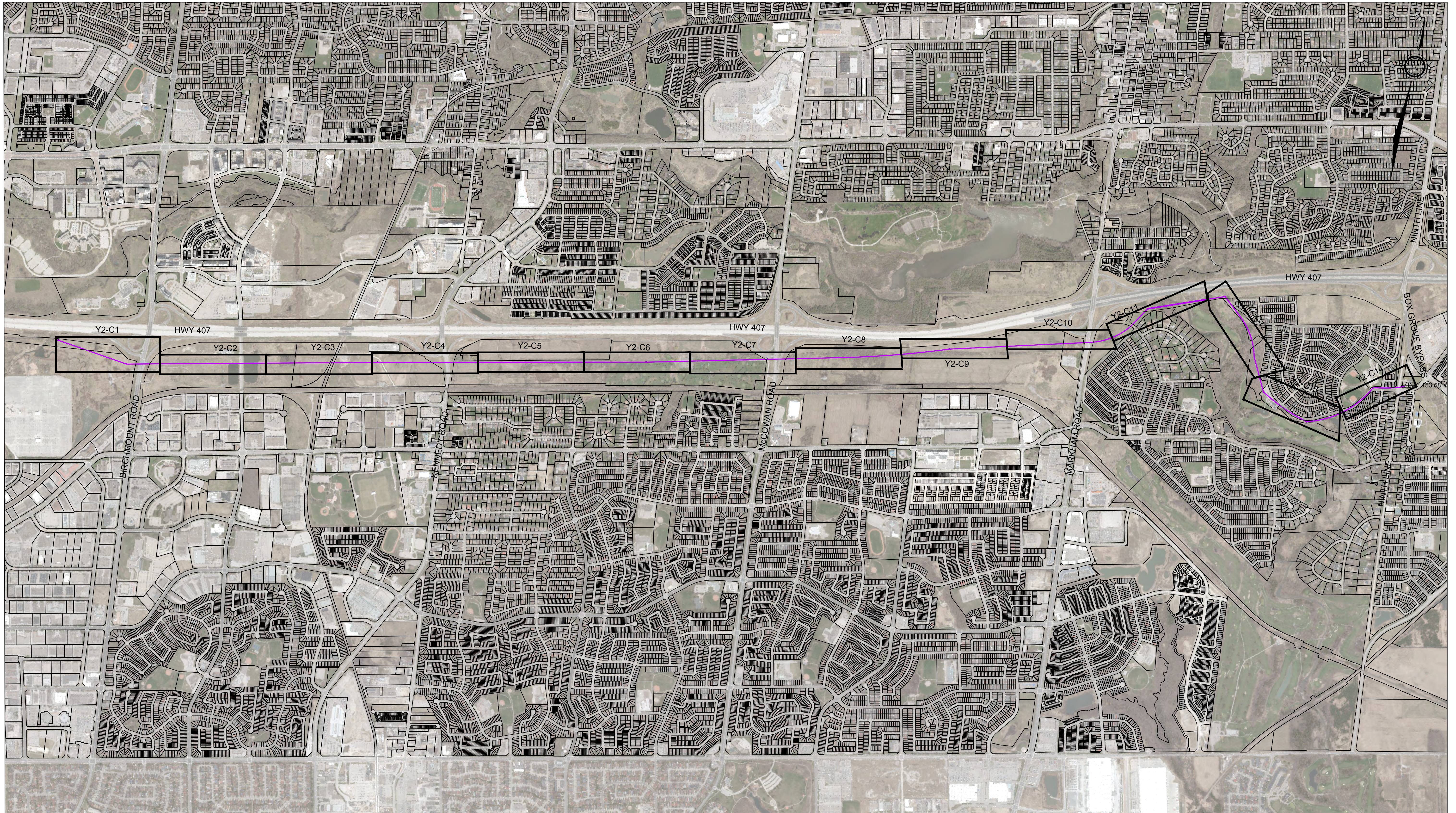

File Location: C:\Users\H068592\OneDrive - Jacobs\Y2-MarkhamCollector\Y2-Conceptual Drawings\WIP\MUN\Sheets\Y2-INDEX.dwg Last Saved: August 3, 2023, by H068592 Plotted: August 3, 2023

THE LOCATION OF UTILITIES IS APPROXIMATE ONLY, AND THE EXACT LOCATION SHOULD BE DETERMINED BY CONSULTING THE MUNICIPAL AUTHORITIES AND UTILITY COMPANIES CONCERNED. THE CONTRACTOR SHALL PROVE THE LOCATION OF UTILITIES AND SHALL BE RESPONSIBLE FOR ADEQUATE PROTECTION FROM DAMAGE DURING CONSTRUCTION.

Jacobs

CONSULTANT

SEAL

| No. | DATE | REVISIONS | BY |
|-----|----------|------------------------------|----|
| 0 | AUG 2023 | ISSUED FOR CONCEPTUAL DESIGN | CA |



Regional
Municipality of
York

| | |
|---------|-----------|
| DATE | AUG. 2023 |
| DESIGN | IH |
| DRAWN | CA |
| CHECKED | PP/DB |

YORK REGION SEWAGE WORKS PROJECT
MARKHAM COLLECTOR TWINNING (Y2)
CONCEPTUAL DRAWINGS
SHEET INDEX

| | |
|-----------------|--------------|
| SCALE | 1" = 1000' |
| DWG. NO. | |
| CLIENT REF. NO. | 75320-E18031 |
| SHEET NO. | INDEX |

SCALE CHECK

UTILITY LEGEND

- EXISTING SANITARY
- EXISTING STORM
- EXISTING WATER
- EXISTING GAS
- EXISTING TELECOM
- PROPOSED SANITARY ALIGNMENT
- PROPOSED ALIGNMENT CHAINAGE

NOTES:
EXISTING UTILITY LOCATIONS ARE APPROXIMATE AND OBTAINED FROM AS-BUILT AND GIS DATA.

OPEN CUT CONSTRUCTION IS PROPOSED BUT THERE IS AN OPPORTUNITY TO TUNNEL DEPENDING ON SITE CONDITIONS AND FURTHER ASSESSMENT DURING THE DESIGN STAGE.

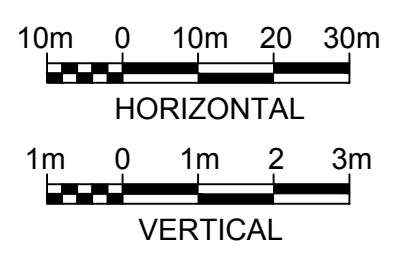
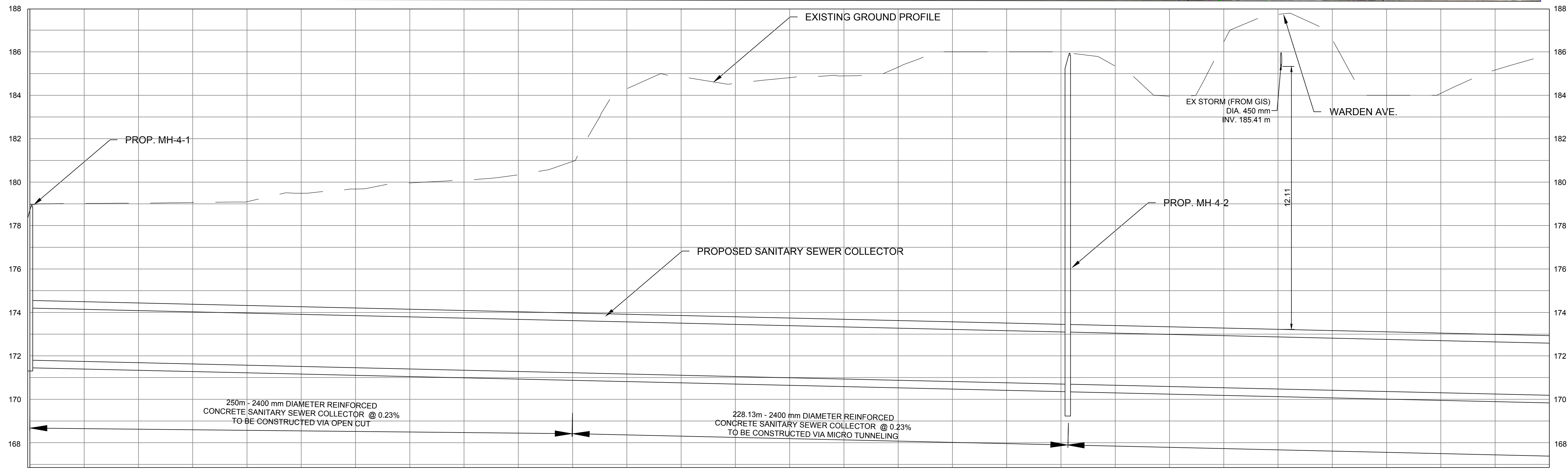
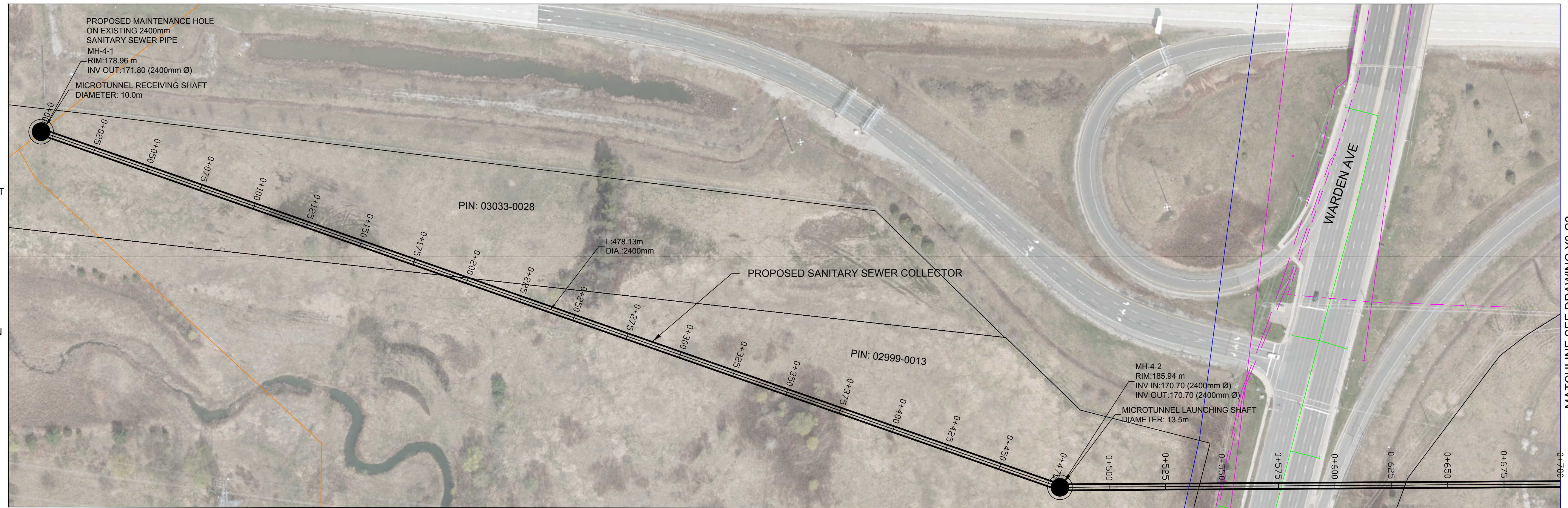
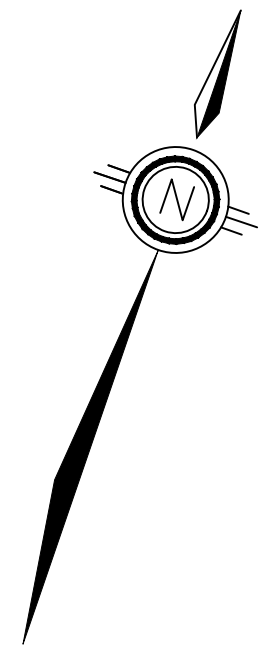

| | |
|------------------------|----------|
| STRUCTURE NAME | MH-4-1 |
| GROUND EL. (m) | 178.96 |
| PIPE INVERT LEVEL (m) | 177.80 |
| PIPE LINE CHAINAGE (m) | 0+000.00 |

| | |
|------------------------|----------|
| STRUCTURE NAME | MH-4-2 |
| GROUND EL. (m) | 185.94 |
| PIPE INVERT LEVEL (m) | 170.70 |
| PIPE LINE CHAINAGE (m) | 0+475.00 |

File Location: C:\Users\H068592\OneDrive - Jacobs\12-MarkhamCollector\12-Conceptual Drawings\12-MUN\Sheets\12-C1.dwg Last Saved: August 25, 2023, by H068592 Plotted: August 25, 2023

THE LOCATION OF UTILITIES IS APPROXIMATE ONLY, AND THE EXACT LOCATION SHOULD BE DETERMINED BY CONSULTING THE MUNICIPAL AUTHORITIES AND UTILITY COMPANIES CONCERNED. THE CONTRACTOR SHALL PROVE THE LOCATION OF UTILITIES AND SHALL BE RESPONSIBLE FOR ADEQUATE PROTECTION FROM DAMAGE DURING CONSTRUCTION.



| No. | DATE | REVISIONS | BY |
|-----|----------|------------------------------|----|
| 0 | AUG 2023 | ISSUED FOR CONCEPTUAL DESIGN | CA |



| | |
|---------|-----------|
| DATE | AUG. 2023 |
| DESIGN | IH |
| DRAWN | CA |
| CHECKED | PP/DB |

YORK REGION SEWAGE WORKS PROJECT
MARKHAM COLLECTOR TWINNING (Y2)
CONCEPTUAL DRAWINGS
PLAN AND PROFILE
STA 0+000 TO STA 0+700

| | |
|-----------------|-------------------------|
| SCALE | H = 1:1000 V = 1:100 |
| DWG. NO. | Y2-C1 |
| CLIENT REF. NO. | 75320-EI18031 |
| SHEET NO. | 1 |

MATCHLINE SEE DRAWING Y2-C2

UTILITY LEGEND

- EXISTING SANITARY
- EXISTING STORM
- EXISTING WATER
- EXISTING GAS
- EXISTING TELECOM
- = PROPOSED SANITARY ALIGNMENT
- | PROPOSED ALIGNMENT CHAINAGE

NOTE: EXISTING UTILITY LOCATIONS ARE APPROXIMATE AND OBTAINED FROM AS-BUILT AND GIS DATA.

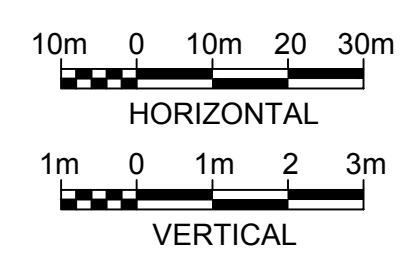
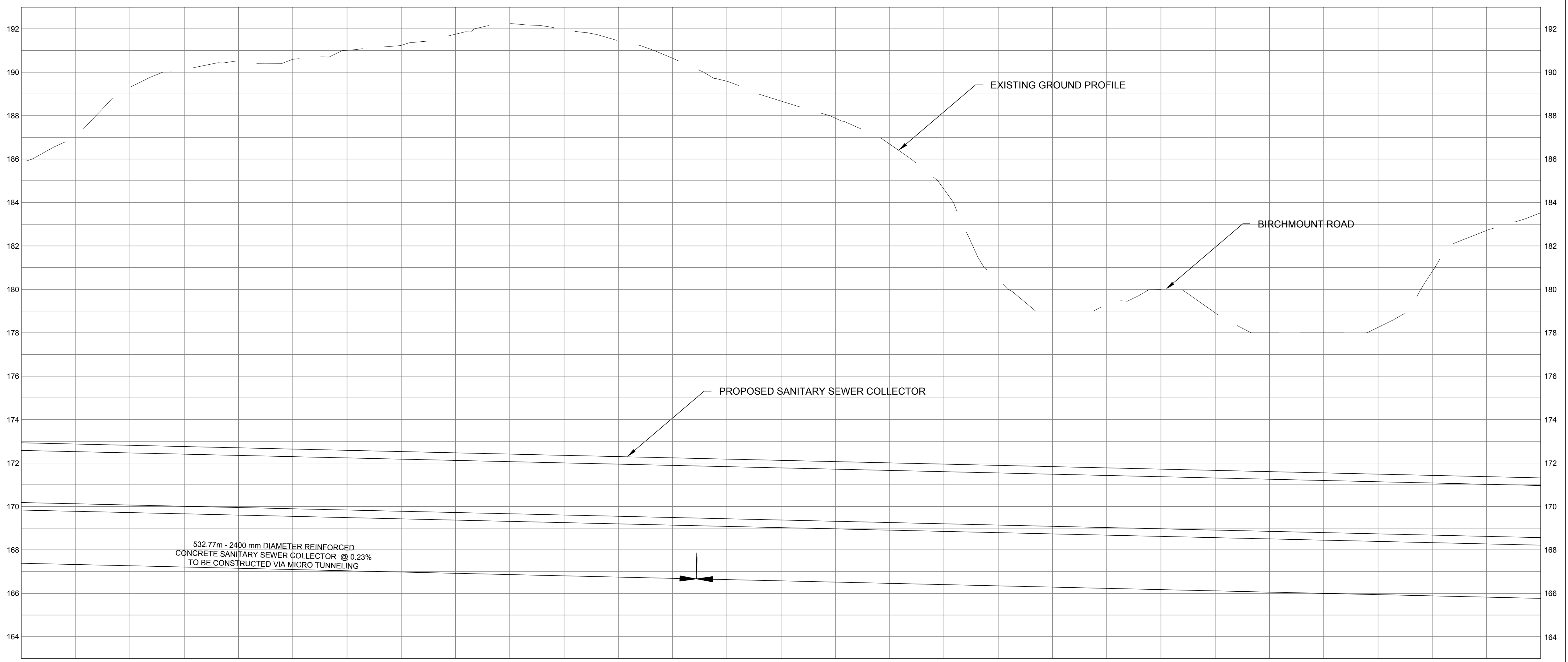
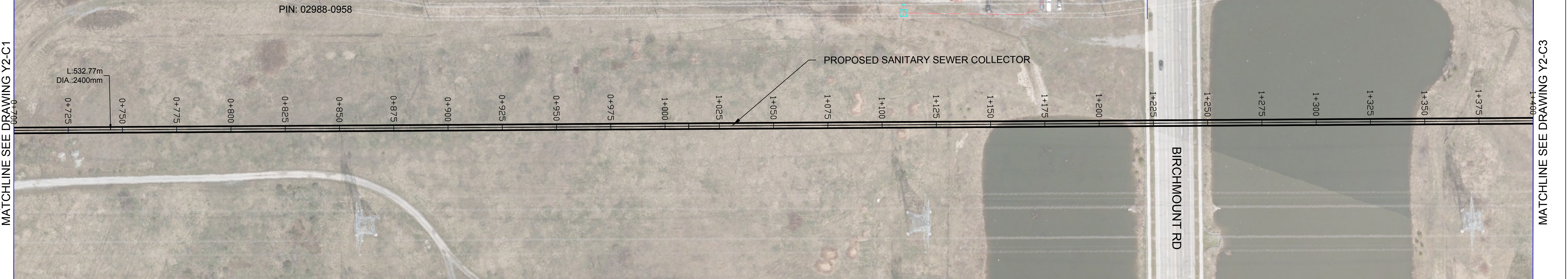

| STRUCTURE NAME | | | | | | | | | | | | | | | | | | | | | | | | | | | | | |
|------------------------|----------|----------|----------|----------|----------|----------|----------|----------|----------|----------|----------|----------|----------|----------|----------|----------|----------|----------|----------|----------|----------|----------|----------|----------|----------|----------|----------|----------|----------|
| GROUND EL. (m) | | | | | | | | | | | | | | | | | | | | | | | | | | | | | |
| PIPE INVERT LEVEL (m) | | | | | | | | | | | | | | | | | | | | | | | | | | | | | |
| PIPE LINE CHAINAGE (m) | 0+700.00 | 0+725.00 | 0+750.00 | 0+775.00 | 0+800.00 | 0+825.00 | 0+850.00 | 0+875.00 | 0+900.00 | 0+925.00 | 0+950.00 | 0+975.00 | 1+000.00 | 1+025.00 | 1+050.00 | 1+075.00 | 1+100.00 | 1+125.00 | 1+150.00 | 1+175.00 | 1+200.00 | 1+225.00 | 1+250.00 | 1+275.00 | 1+300.00 | 1+325.00 | 1+350.00 | 1+375.00 | 1+400.00 |
| | | | | | | | | | | | | | | | | | | | | | | | | | | | | | |

THE LOCATION OF UTILITIES IS APPROXIMATE ONLY, AND THE EXACT LOCATION SHOULD BE DETERMINED BY CONSULTING THE MUNICIPAL AUTHORITIES AND UTILITY COMPANIES CONCERNED. THE CONTRACTOR SHALL PROVE THE LOCATION OF UTILITIES AND SHALL BE RESPONSIBLE FOR ADEQUATE PROTECTION FROM DAMAGE DURING CONSTRUCTION.

CONSULTANT

Jacobs

| No. | DATE | REVISIONS | BY |
|-----|----------|------------------------------|----|
| 0 | AUG 2023 | ISSUED FOR CONCEPTUAL DESIGN | CA |

York Region Municipality of York

| | |
|---------|-----------|
| DATE | AUG. 2023 |
| DESIGN | IH |
| DRAWN | CA |
| CHECKED | PP/DB |

YORK REGION SEWAGE WORKS PROJECT
 MARKHAM COLLECTOR TWINNING (Y2)
 CONCEPTUAL DRAWINGS
 PLAN AND PROFILE
 STA 0+700 TO STA 1+400

| | |
|-----------------|-------------------------|
| SCALE | H = 1:1000 V = 1:100 |
| DWG. NO. | Y2-C2 |
| CLIENT REF. NO. | 75320-EI18031 |
| SHEET NO. | 2 |

File Location: C:\Users\IH068592\OneDrive - Jacobs\Y2-MarkhamCollector\Y2-Conceptual Drawings\WIP\MUN\Sheets\Y2-C2.dwg Last Saved: August 6, 2023, by IH068592 Plotted: August 25, 2023

UTILITY LEGEND

- EXISTING SANITARY
- EXISTING STORM
- EXISTING WATER
- EXISTING GAS
- EXISTING TELECOM
- PROPOSED SANITARY ALIGNMENT
- PROPOSED ALIGNMENT CHAINAGE

NOTE: EXISTING UTILITY LOCATIONS ARE APPROXIMATE AND OBTAINED FROM AS-BUILT AND GIS DATA.

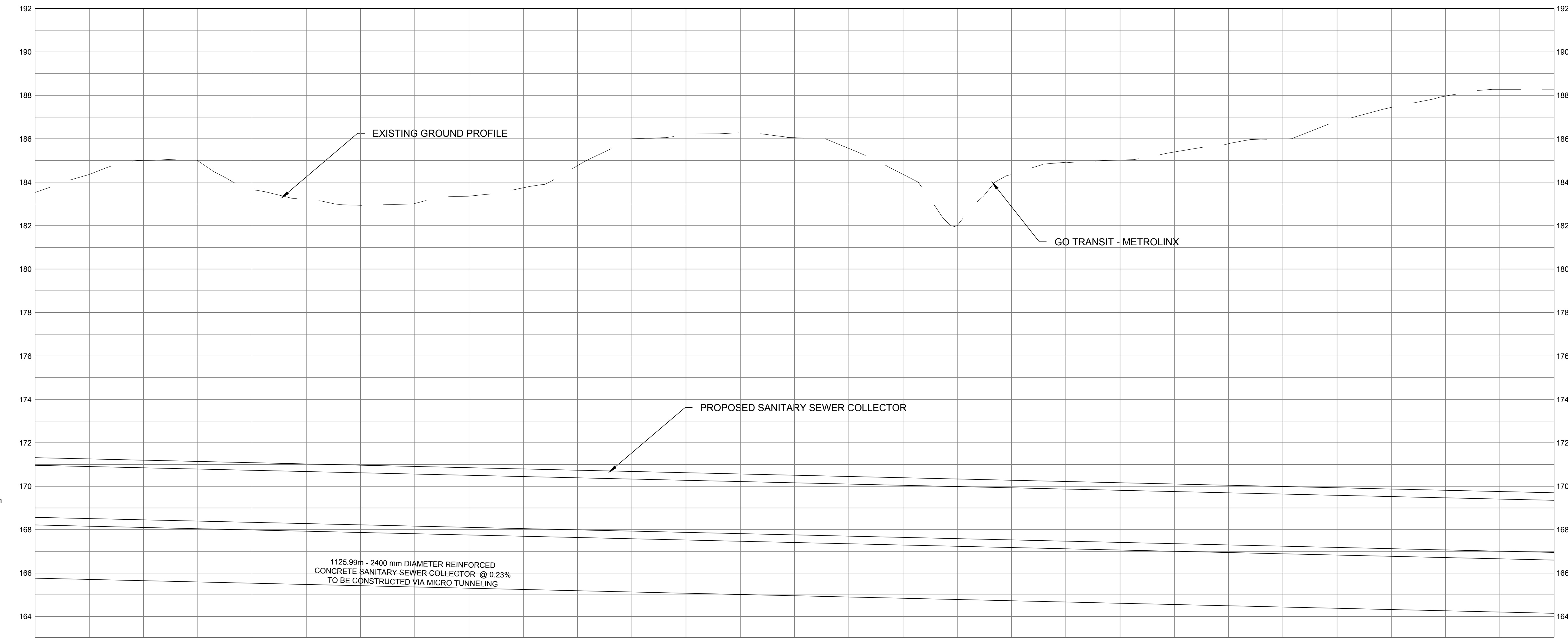
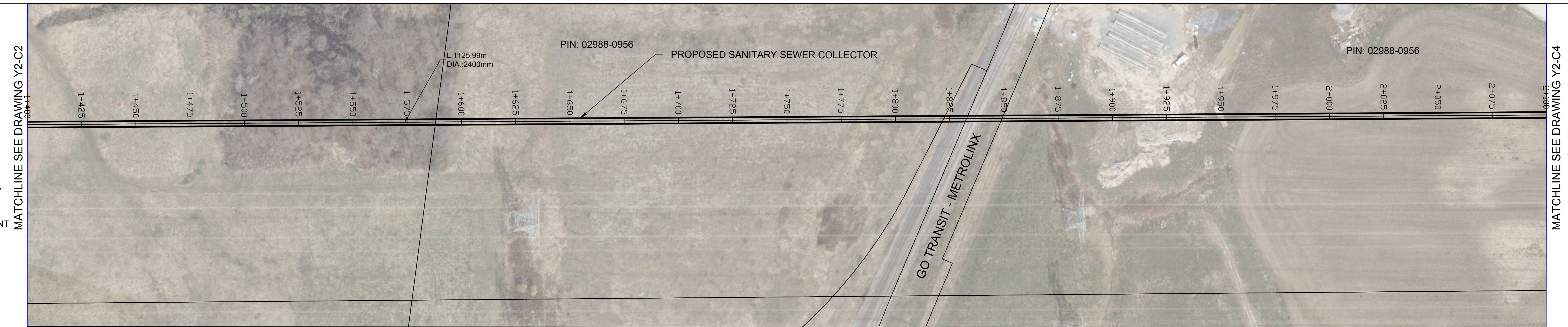
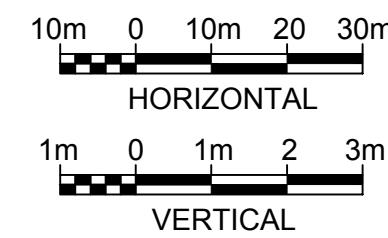
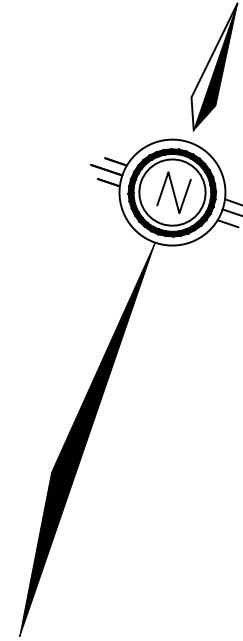

| | |
|------------------------|----------------------------------------------------------------------------------------------------------------------------------------------------------------------------------------------------------------------------------------------------------------------|
| STRUCTURE NAME | |
| GROUND EL. (m) | |
| PIPE INVERT LEVEL (m) | |
| PIPE LINE CHAINAGE (m) | 1+400.00 1+425.00 1+450.00 1+475.00 1+500.00 1+525.00 1+550.00 1+575.00 1+600.00 1+625.00 1+650.00 1+675.00 1+700.00 1+725.00 1+750.00 1+775.00 1+800.00 1+825.00 1+850.00 1+875.00 1+900.00 1+925.00 1+950.00 1+975.00 2+000.00 2+025.00 2+050.00 2+075.00 2+100.00 |

File Location: C:\Users\H068592\OneDrive - Jacobs\12-MarkhamCollector\12-Conceptual Drawings\12-MUN\Sheets\Y2-C3.dwg Last Saved: August 6, 2023, by H068592 Plotted: August 25, 2023

THE LOCATION OF UTILITIES IS APPROXIMATE ONLY, AND THE EXACT LOCATION SHOULD BE DETERMINED BY CONSULTING THE MUNICIPAL AUTHORITIES AND UTILITY COMPANIES CONCERNED. THE CONTRACTOR SHALL PROVE THE LOCATION OF UTILITIES AND SHALL BE RESPONSIBLE FOR ADEQUATE PROTECTION FROM DAMAGE DURING CONSTRUCTION.



CONSULTANT

SEAL

| No. | DATE | REVISIONS | BY |
|-----|----------|------------------------------|----|
| 0 | AUG 2023 | ISSUED FOR CONCEPTUAL DESIGN | CA |



Regional Municipality of York

| | |
|---------|-----------|
| DATE | AUG. 2023 |
| DESIGN | IH |
| DRAWN | CA |
| CHECKED | PP/DB |

YORK REGION SEWAGE WORKS PROJECT
MARKHAM COLLECTOR TWINNING (Y2)
 CONCEPTUAL DRAWINGS
 PLAN AND PROFILE
 STA 1+400 TO STA 2+100

| | |
|-----------------|-------------------------|
| SCALE | H = 1:1000 V = 1:100 |
| DWG. NO. | Y2-C3 |
| CLIENT REF. NO. | 75320-EI18031 |
| SHEET NO. | 3 |

SCALE CHECK

UTILITY LEGEND

- EXISTING SANITARY
- EXISTING STORM
- EXISTING WATER
- EXISTING GAS
- EXISTING TELECOM
- PROPOSED SANITARY ALIGNMENT
- PROPOSED ALIGNMENT CHAINAGE

NOTE: EXISTING UTILITY LOCATIONS ARE APPROXIMATE AND OBTAINED FROM AS-BUILT AND GIS DATA.

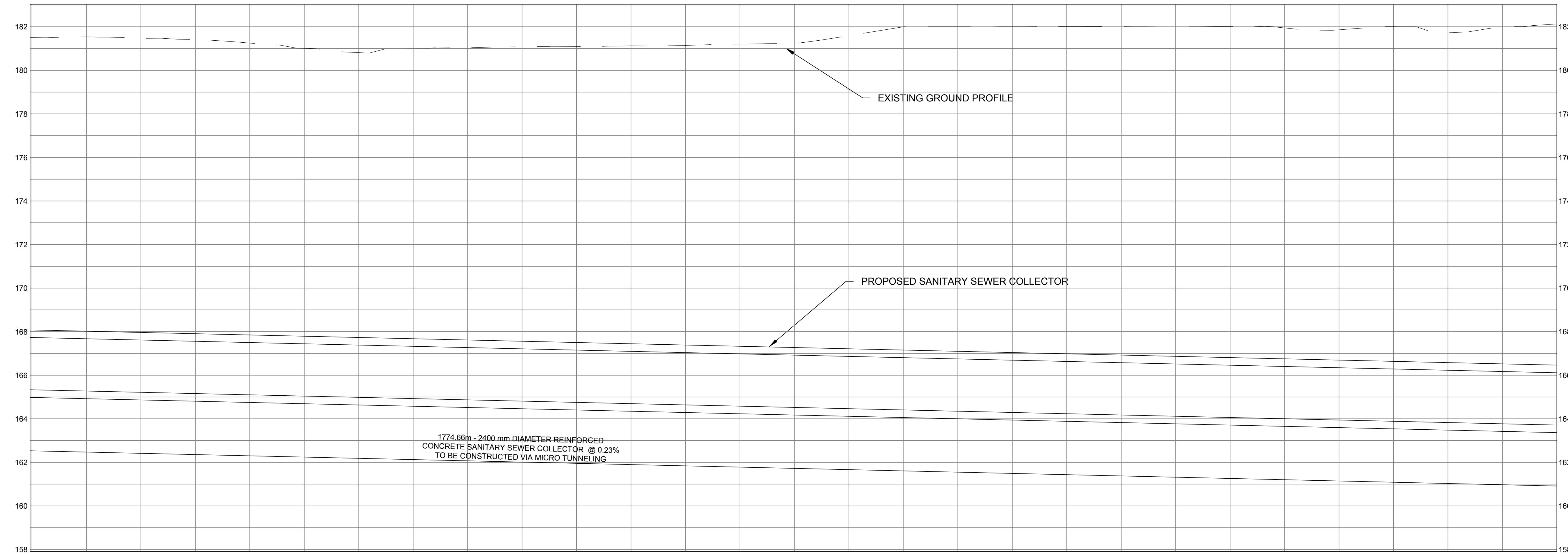
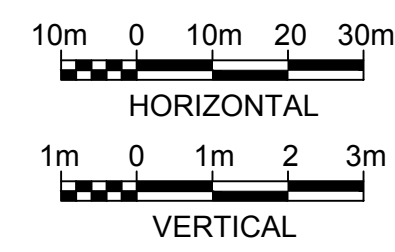
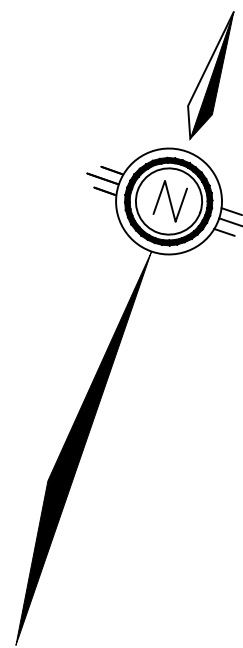

| | |
|------------------------|----------------------------------------------------------------------------------------------------------------------------------------------------------------------------------------------------------------------------------------------------------------------------------------------------------------------------------------------------------|
| STRUCTURE NAME | |
| GROUND EL. (m) | |
| PIPE INVERT LEVEL (m) | |
| PIPE LINE CHAINAGE (m) | 2+800.00 2+825.00 2+850.00 2+875.00 2+900.00 2+925.00 2+950.00 2+975.00 3+000.00 3+025.00 3+050.00 3+075.00 3+100.00 3+125.00 3+150.00 3+175.00 3+200.00 3+225.00 3+250.00 3+275.00 3+300.00 3+325.00 3+350.00 3+375.00 3+400.00 3+425.00 3+450.00 3+475.00 3+500.00 |

File Location: C:\Users\H068592\OneDrive - Jacobs\12-MarkhamCollector\Y2-Conceptual Drawings\WIP\MUN\Sheets\Y2-C5.dwg Last Saved: August 25, 2023, by H068592 Plotted: August 25, 2023

THE LOCATION OF UTILITIES IS APPROXIMATE ONLY, AND THE EXACT LOCATION SHOULD BE DETERMINED BY CONSULTING THE MUNICIPAL AUTHORITIES AND UTILITY COMPANIES CONCERNED. THE CONTRACTOR SHALL PROVE THE LOCATION OF UTILITIES AND SHALL BE RESPONSIBLE FOR ADEQUATE PROTECTION FROM DAMAGE DURING CONSTRUCTION.

| | | |
|--------------------|------|--|
| CONSULTANT | SEAL | |
|--------------------|------|--|

| No. | DATE | REVISIONS | BY |
|-----|----------|------------------------------|----|
| 0 | AUG 2023 | ISSUED FOR CONCEPTUAL DESIGN | CA |

Regional
Municipality of
York

| | | |
|----------------------------------------------------------------------------------|--------------------------------------------------------------------------------------------------------------------------------------------------|-------------------------------------------------------------------------------------------------------------------------|
| DATE AUG. 2023 DESIGN IH DRAWN CA CHECKED PP/DB | YORK REGION SEWAGE WORKS PROJECT MARKHAM COLLECTOR TWINNING (Y2) CONCEPTUAL DRAWINGS PLAN AND PROFILE STA 2+800 TO STA 3+500 | SCALE H = 1:1000 V = 1:100 DWG. NO. Y2-C5 CLIENT REF. NO. 75320-EI18031 SHEET NO. 5 |
|----------------------------------------------------------------------------------|--------------------------------------------------------------------------------------------------------------------------------------------------|-------------------------------------------------------------------------------------------------------------------------|

SCALE CHECK

UTILITY LEGEND

- EXISTING SANITARY
- EXISTING STORM
- EXISTING WATER
- EXISTING GAS
- EXISTING TELECOM
- PROPOSED SANITARY ALIGNMENT
- PROPOSED ALIGNMENT CHAINAGE

NOTE: EXISTING UTILITY LOCATIONS ARE APPROXIMATE AND OBTAINED FROM AS-BUILT AND GIS DATA.

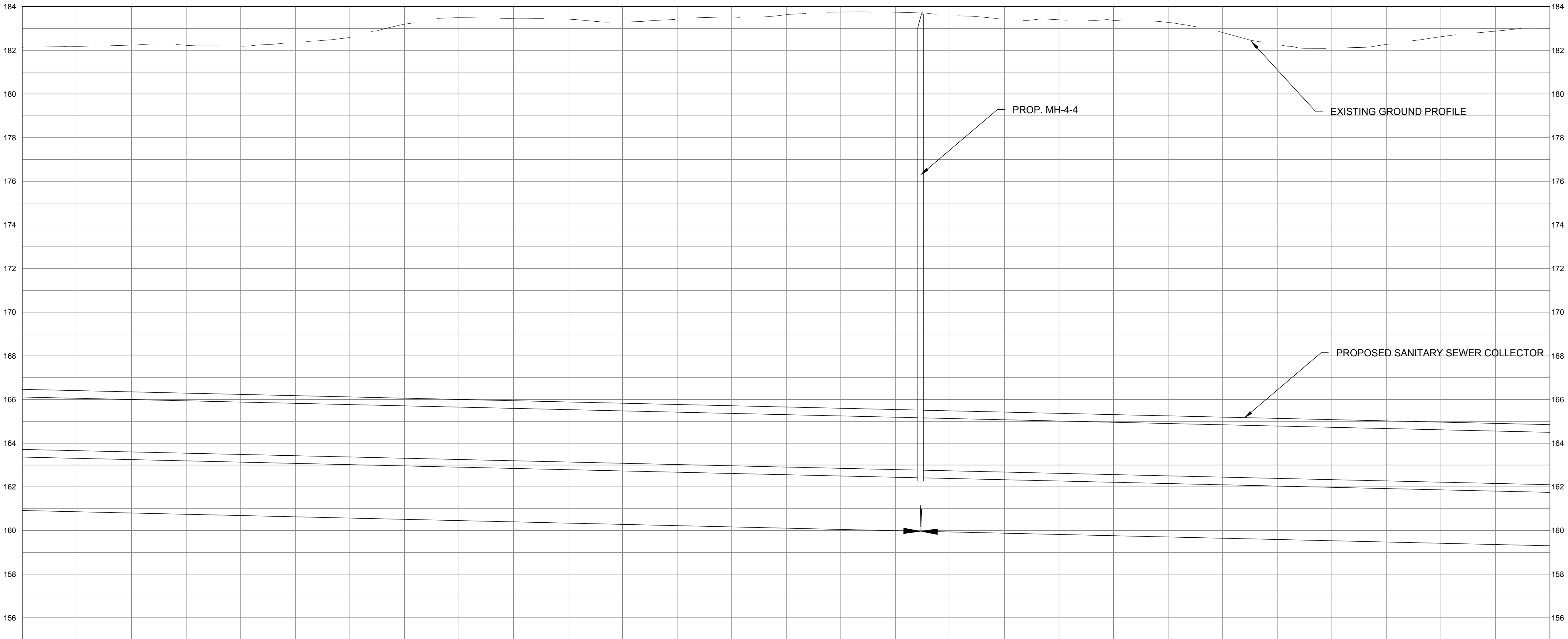
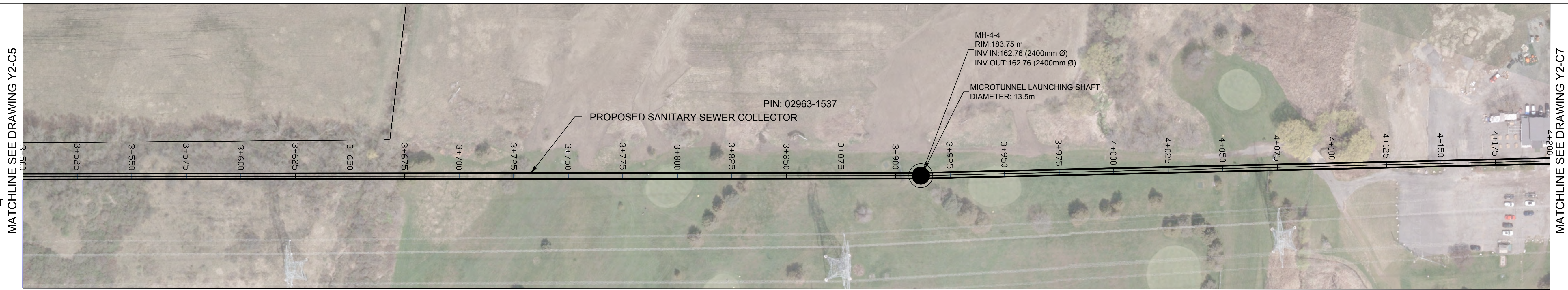
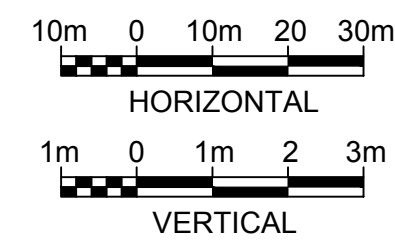
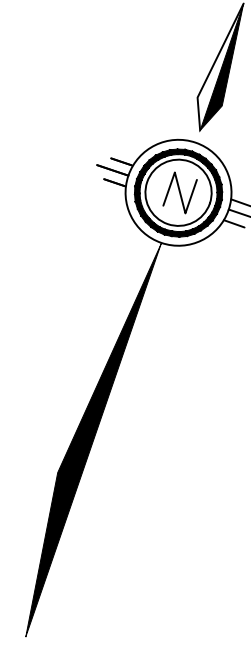

STRUCTURE NAME
GROUND EL. (m)
PIPE INVERT LEVEL (m)
PIPE LINE CHAINAGE (m)

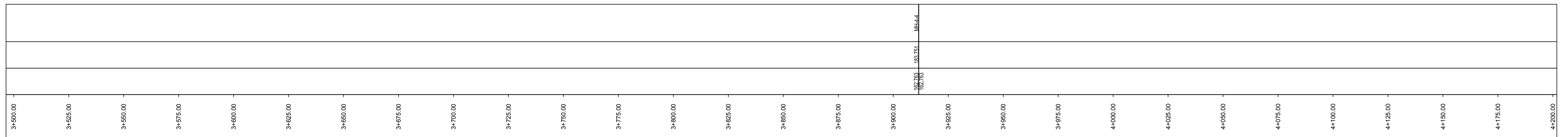

File Location: C:\Users\jhd68592\OneDrive - Jacobs\12-MarkhamCollector\12-Conceptual Drawings\WIP\MUN\Sheets\Y2-C6.dwg Last Saved: August 8, 2023, by jhd68592 Plotted: August 25, 2023

CONSULTANT

Jacobs

| No. | DATE | REVISIONS | BY |
|-----|----------|------------------------------|----|
| 0 | AUG 2023 | ISSUED FOR CONCEPTUAL DESIGN | CA |

Regional Municipality of York

| | | |
|-------------------|---------------------------------------------------------------------|----------------------------------|
| DATE AUG. 2023 | YORK REGION SEWAGE WORKS PROJECT MARKHAM COLLECTOR TWINNING (Y2) | SCALE H = 1:1000 V = 1:100 |
| DESIGN IH | | DWG. NO. Y2-C6 |
| DRAWN CA | | CLIENT REF. NO. 75320-EI18031 |
| CHECKED PP/DB | | SHEET NO. 6 |

SCALE CHECK

UTILITY LEGEND

- EXISTING SANITARY
- EXISTING STORM
- EXISTING WATER
- EXISTING GAS
- EXISTING TELECOM
- = PROPOSED SANITARY ALIGNMENT
- = PROPOSED ALIGNMENT CHAINAGE

NOTE: EXISTING UTILITY LOCATIONS ARE APPROXIMATE AND OBTAINED FROM AS-BUILT AND GIS DATA.

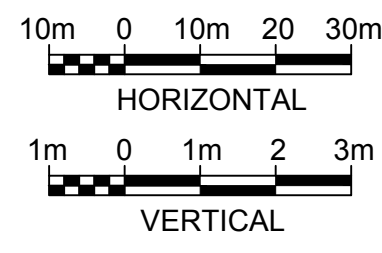
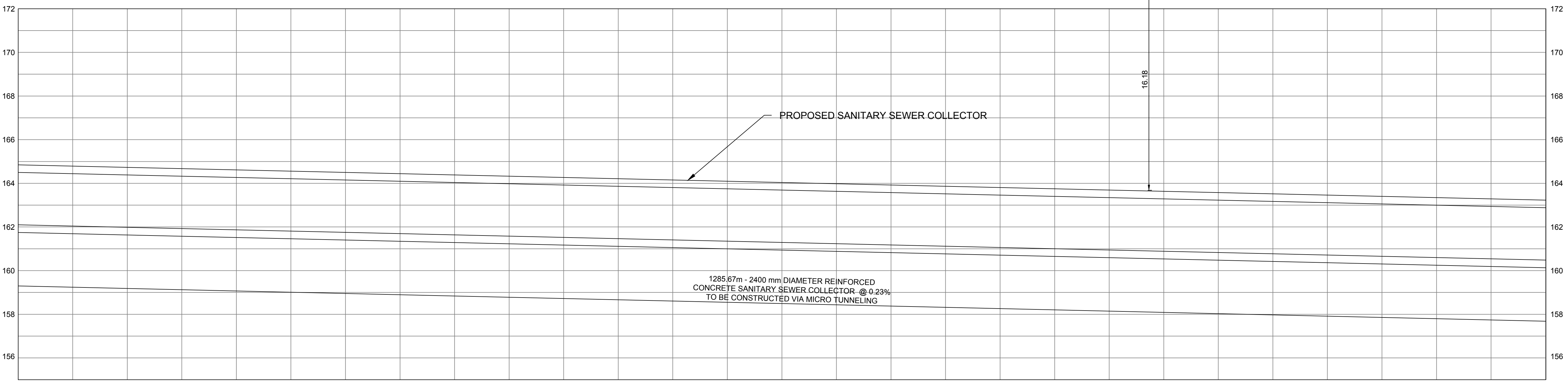
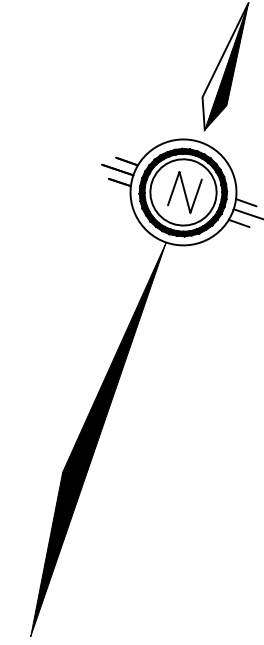

| | |
|------------------------|--|
| STRUCTURE NAME | |
| GROUND EL. (m) | |
| PIPE INVERT LEVEL (m) | |
| PIPE LINE CHAINAGE (m) | |

| | | | | | | | | | | | | | | | | | | | | | | | | | | | | |
|----------|----------|----------|----------|----------|----------|----------|----------|----------|----------|----------|----------|----------|----------|----------|----------|----------|----------|----------|----------|----------|----------|----------|----------|----------|----------|----------|----------|----------|
| 4+200.00 | 4+225.00 | 4+250.00 | 4+275.00 | 4+300.00 | 4+325.00 | 4+350.00 | 4+375.00 | 4+400.00 | 4+425.00 | 4+450.00 | 4+475.00 | 4+500.00 | 4+525.00 | 4+550.00 | 4+575.00 | 4+600.00 | 4+625.00 | 4+650.00 | 4+675.00 | 4+700.00 | 4+725.00 | 4+750.00 | 4+775.00 | 4+800.00 | 4+825.00 | 4+850.00 | 4+875.00 | 4+900.00 |
|----------|----------|----------|----------|----------|----------|----------|----------|----------|----------|----------|----------|----------|----------|----------|----------|----------|----------|----------|----------|----------|----------|----------|----------|----------|----------|----------|----------|----------|

File Location: C:\Users\jhd68592\OneDrive - Jacobs\12-MarkhamCollector\12-Conceptual Drawings\12-C7.dwg Last Saved: August 8, 2023, by jhd68592 Plotted: August 25, 2023

THE LOCATION OF UTILITIES IS APPROXIMATE ONLY, AND THE EXACT LOCATION SHOULD BE DETERMINED BY CONSULTING THE MUNICIPAL AUTHORITIES AND UTILITY COMPANIES CONCERNED. THE CONTRACTOR SHALL PROVE THE LOCATION OF UTILITIES AND SHALL BE RESPONSIBLE FOR ADEQUATE PROTECTION FROM DAMAGE DURING CONSTRUCTION.

CONSULTANT
Jacobs

SEAL

| No. | DATE | REVISIONS | BY |
|-----|----------|------------------------------|----|
| 0 | AUG 2023 | ISSUED FOR CONCEPTUAL DESIGN | CA |

| | |
|---------|-----------|
| DATE | AUG. 2023 |
| DESIGN | IH |
| DRAWN | CA |
| CHECKED | PP/DB |

YORK REGION SEWAGE WORKS PROJECT
MARKHAM COLLECTOR TWINNING (Y2)
CONCEPTUAL DRAWINGS
PLAN AND PROFILE
STA 4+200 TO STA 4+900

| | |
|-----------------|-------------------------|
| SCALE | H = 1:1000 V = 1:100 |
| DWG. NO. | Y2-C7 |
| CLIENT REF. NO. | 75320-E118031 |
| SHEET NO. | 7 |

SCALE CHECK

UTILITY LEGEND

- EXISTING SANITARY
- EXISTING STORM
- EXISTING WATER
- EXISTING GAS
- EXISTING TELECOM
- PROPOSED SANITARY ALIGNMENT
- PROPOSED ALIGNMENT CHAINAGE

NOTE: EXISTING UTILITY LOCATIONS ARE APPROXIMATE AND OBTAINED FROM AS-BUILT AND GIS DATA.

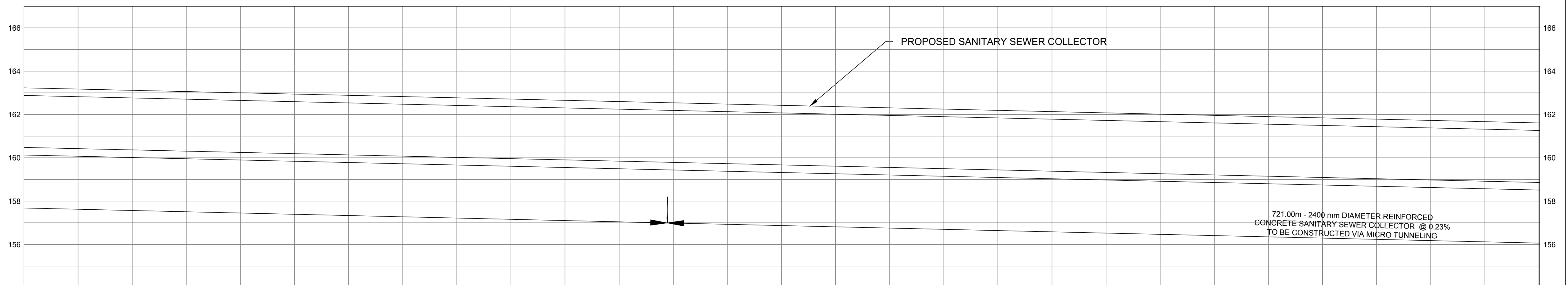
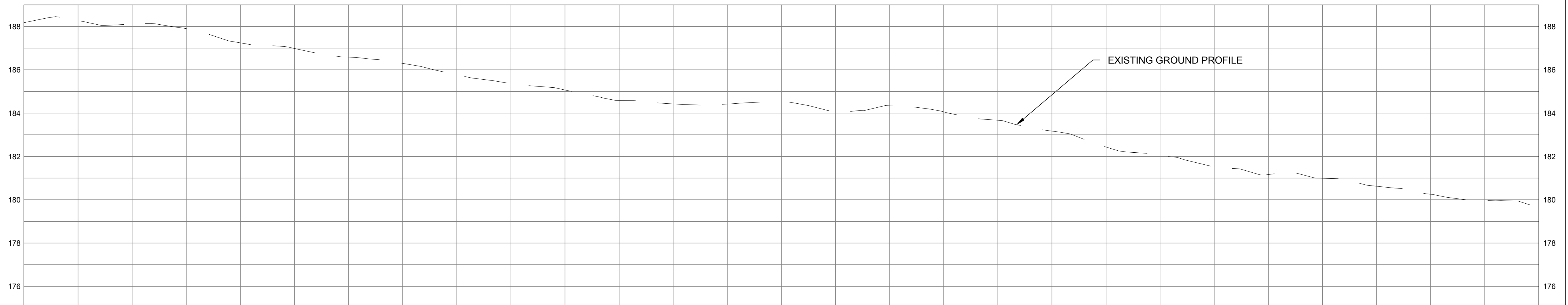
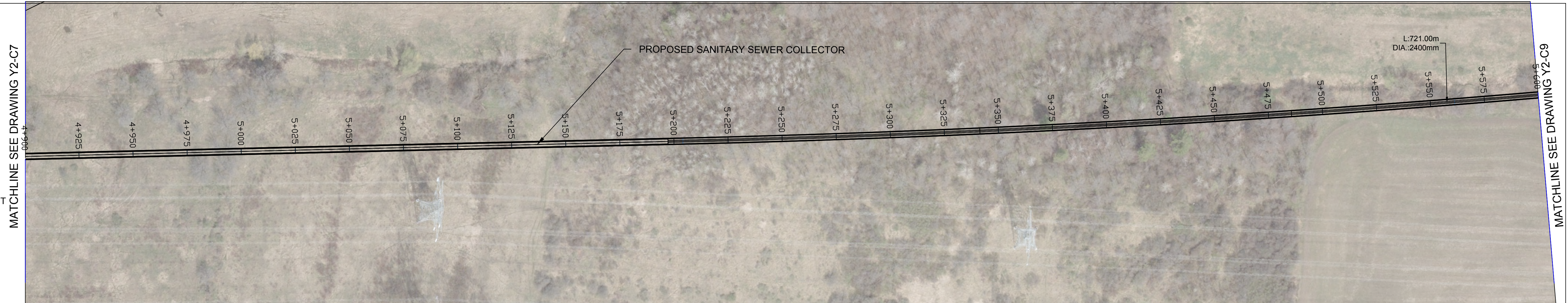
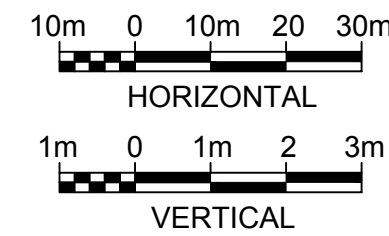
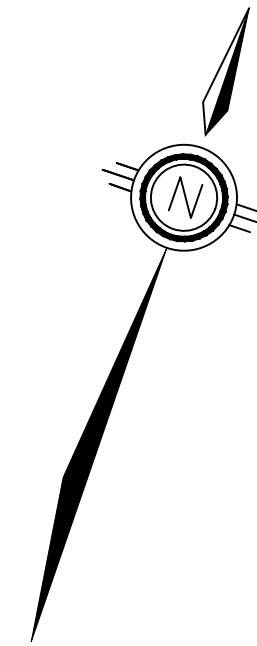

| STRUCTURE NAME | |
|------------------------|--------------------------------------------------------------------------------------------------------------------------------------------------------------------------------------------------------------------------------------------------------------------------------------------------|
| GROUND EL. (m) | |
| PIPE INVERT LEVEL (m) | |
| PIPE LINE CHAINAGE (m) | 4+900.00, 4+925.00, 4+950.00, 4+975.00, 5+000.00, 5+025.00, 5+050.00, 5+075.00, 5+100.00, 5+125.00, 5+150.00, 5+175.00, 5+200.00, 5+225.00, 5+250.00, 5+275.00, 5+300.00, 5+325.00, 5+350.00, 5+375.00, 5+400.00, 5+425.00, 5+450.00, 5+475.00, 5+500.00, 5+525.00, 5+550.00, 5+575.00, 5+600.00 |

File Location: C:\Users\jhd68592\OneDrive - Jacobs\12-MarkhamCollector\12-Conceptual Drawings\12-MUN\Sheets\Y2-C8.dwg Last Saved: August 8, 2023, by jhd68592 Plotted: August 25, 2023

THE LOCATION OF UTILITIES IS APPROXIMATE ONLY, AND THE EXACT LOCATION SHOULD BE DETERMINED BY CONSULTING THE MUNICIPAL AUTHORITIES AND UTILITY COMPANIES CONCERNED. THE CONTRACTOR SHALL PROVE THE LOCATION OF UTILITIES AND SHALL BE RESPONSIBLE FOR ADEQUATE PROTECTION FROM DAMAGE DURING CONSTRUCTION.

CONSULTANT
Jacobs

SEAL

| No. | DATE | REVISIONS | BY |
|-----|----------|------------------------------|----|
| 0 | AUG 2023 | ISSUED FOR CONCEPTUAL DESIGN | CA |

Regional Municipality of York

| |
|-------------------|
| DATE AUG. 2023 |
| DESIGN IH |
| DRAWN CA |
| CHECKED PP/DB |

YORK REGION SEWAGE WORKS PROJECT
MARKHAM COLLECTOR TWINNING (Y2)
 CONCEPTUAL DRAWINGS
 PLAN AND PROFILE
 STA 4+900 TO STA 5+600

| |
|----------------------------------|
| SCALE H = 1:1000 V = 1:100 |
| DWG. NO. Y2-C8 |
| CLIENT REF. NO. 75320-EI18031 |
| SHEET NO. 8 |

SCALE CHECK

UTILITY LEGEND

- EXISTING SANITARY
- EXISTING STORM
- EXISTING WATER
- EXISTING GAS
- EXISTING TELECOM
- PROPOSED SANITARY ALIGNMENT
- PROPOSED ALIGNMENT CHAINAGE

NOTE: EXISTING UTILITY LOCATIONS ARE APPROXIMATE AND OBTAINED FROM AS-BUILT AND GIS DATA.

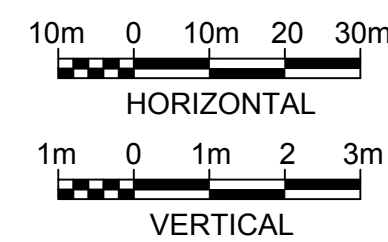
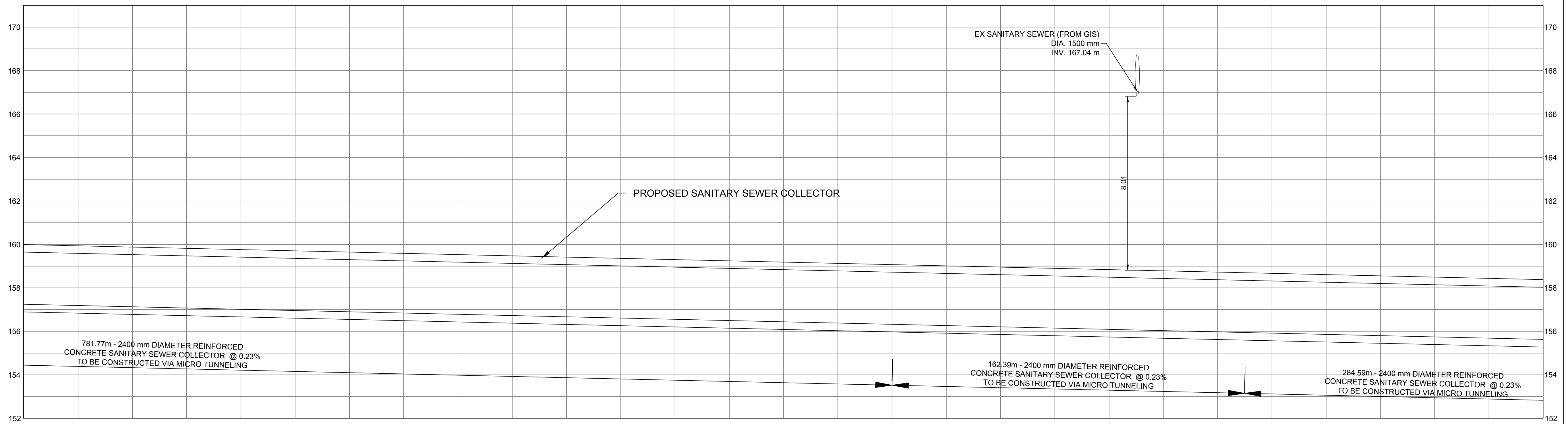
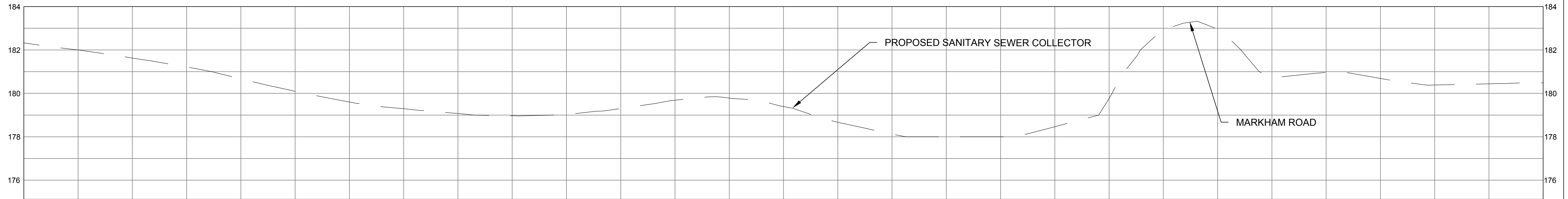
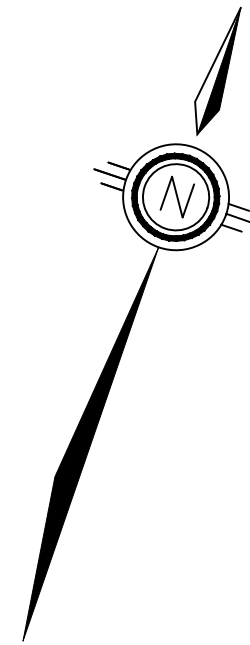

| STRUCTURE NAME | GROUND EL. (m) | PIPE INVERT LEVEL (m) | PIPE LINE CHAINAGE (m) |
|----------------|----------------|-----------------------|------------------------|
| | | | 6+300.00 |
| | | | 6+325.00 |
| | | | 6+350.00 |
| | | | 6+375.00 |
| | | | 6+400.00 |
| | | | 6+425.00 |
| | | | 6+450.00 |
| | | | 6+475.00 |
| | | | 6+500.00 |
| | | | 6+525.00 |
| | | | 6+550.00 |
| | | | 6+575.00 |
| | | | 6+600.00 |
| | | | 6+625.00 |
| | | | 6+650.00 |
| | | | 6+675.00 |
| | | | 6+700.00 |
| | | | 6+725.00 |
| | | | 6+750.00 |
| | | | 6+775.00 |
| | | | 6+800.00 |
| | | | 6+825.00 |
| | | | 6+850.00 |
| | | | 6+875.00 |
| | | | 6+900.00 |
| | | | 6+925.00 |
| | | | 6+950.00 |
| | | | 6+975.00 |
| | | | 7+000.00 |

File Location: C:\Users\H068592\OneDrive - Jacobs\12-MarkhamCollector\12-Conceptual Drawings\WIP\MUN\Sheets\Y2-C10.dwg Last Saved: August 8, 2023, by H068592 Plotted: August 25, 2023

THE LOCATION OF UTILITIES IS APPROXIMATE ONLY, AND THE EXACT LOCATION SHOULD BE DETERMINED BY CONSULTING THE MUNICIPAL AUTHORITIES AND UTILITY COMPANIES CONCERNED. THE CONTRACTOR SHALL PROVE THE LOCATION OF UTILITIES AND SHALL BE RESPONSIBLE FOR ADEQUATE PROTECTION FROM DAMAGE DURING CONSTRUCTION.

CONSULTANT

Jacobs

SEAL

| No. | DATE | REVISIONS | BY |
|-----|----------|------------------------------|----|
| 0 | AUG 2023 | ISSUED FOR CONCEPTUAL DESIGN | CA |



Regional Municipality of York

| | |
|---------|-----------|
| DATE | AUG. 2023 |
| DESIGN | IH |
| DRAWN | CA |
| CHECKED | PP/DB |

YORK REGION SEWAGE WORKS PROJECT
 MARKHAM COLLECTOR TWINNING (Y2)
 CONCEPTUAL DRAWINGS
 PLAN AND PROFILE
 STA 6+300 TO STA 7+000

| | |
|-----------------|-------------------------|
| SCALE | H = 1:1000 V = 1:100 |
| DWG. NO. | Y2-C10 |
| CLIENT REF. NO. | 75320-EI18031 |
| SHEET NO. | 10 |

SCALE CHECK

UTILITY LEGEND

- EXISTING SANITARY
- EXISTING STORM
- EXISTING WATER
- EXISTING GAS
- EXISTING TELECOM
- = PROPOSED SANITARY ALIGNMENT
- = PROPOSED ALIGNMENT CHAINAGE

NOTE:
 1. EXISTING UTILITY LOCATIONS ARE APPROXIMATE AND OBTAINED FROM AS-BUILT AND GIS DATA.
 2. THE PIPE COVER WILL BE EXAMINED UPON THE COMPLETION OF THE ROUGE RIVER BED SURVEY DURING THE PRELIMINARY DESIGN STAGE

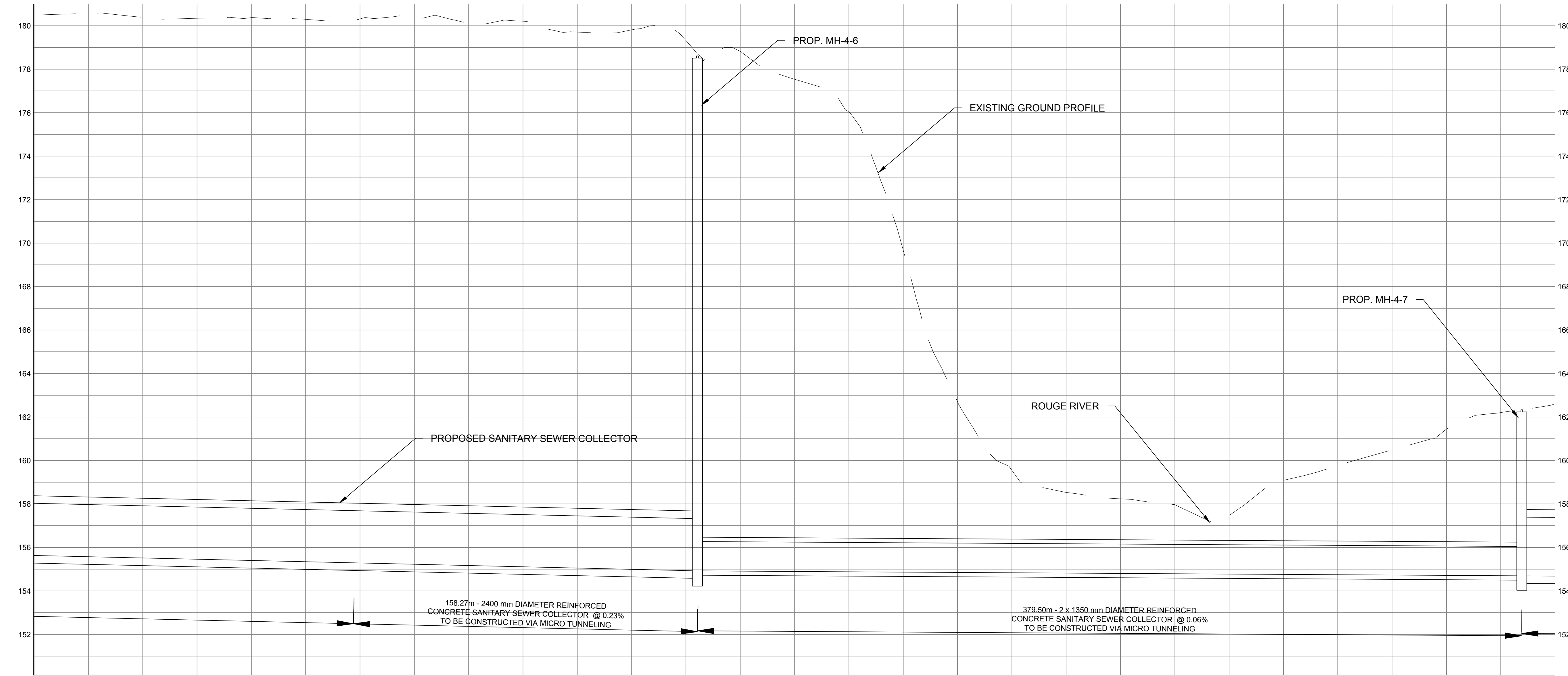
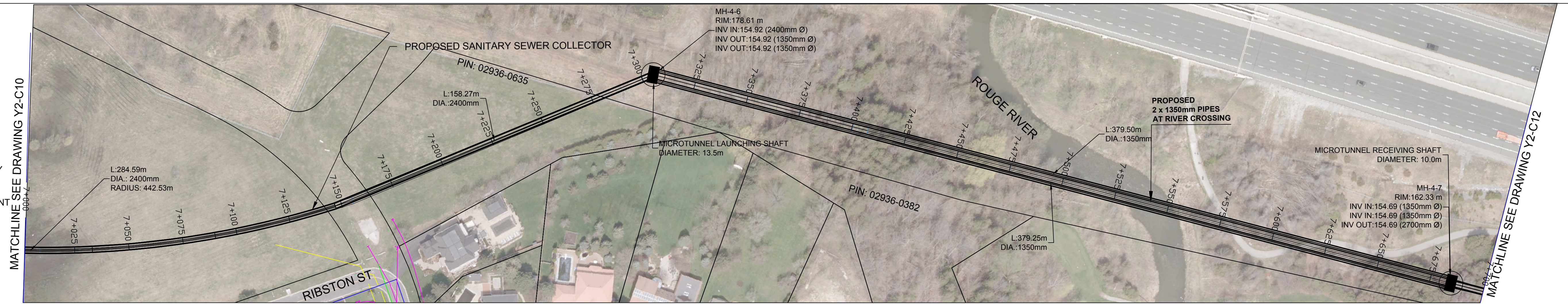
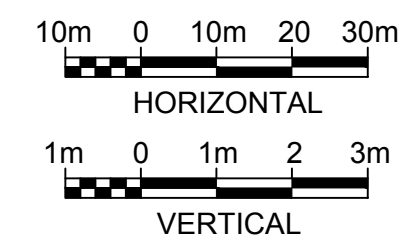
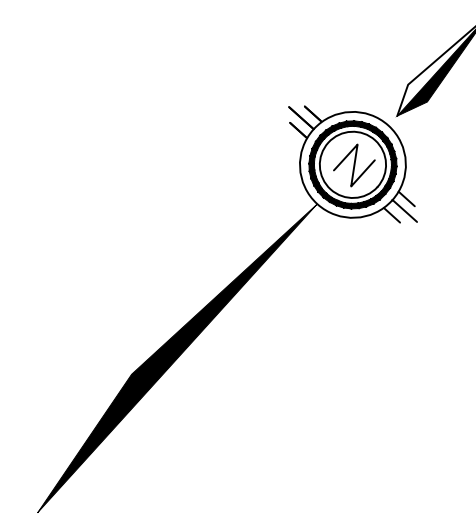

| | |
|------------------------|--|
| STRUCTURE NAME | |
| GROUND EL. (m) | |
| PIPE INVERT LEVEL (m) | |
| PIPE LINE CHAINAGE (m) | |

| | | | | | | | | | | | | | | | | | | | | | | | | | | | | |
|----------|----------|----------|----------|----------|----------|----------|----------|----------|----------|----------|----------|----------|----------|----------|----------|----------|----------|----------|----------|----------|----------|----------|----------|----------|----------|----------|----------|----------|
| 7+000.00 | 7+025.00 | 7+050.00 | 7+075.00 | 7+100.00 | 7+125.00 | 7+150.00 | 7+175.00 | 7+200.00 | 7+225.00 | 7+250.00 | 7+275.00 | 7+300.00 | 7+325.00 | 7+350.00 | 7+375.00 | 7+400.00 | 7+425.00 | 7+450.00 | 7+475.00 | 7+500.00 | 7+525.00 | 7+550.00 | 7+575.00 | 7+600.00 | 7+625.00 | 7+650.00 | 7+675.00 | 7+700.00 |
|----------|----------|----------|----------|----------|----------|----------|----------|----------|----------|----------|----------|----------|----------|----------|----------|----------|----------|----------|----------|----------|----------|----------|----------|----------|----------|----------|----------|----------|

File Location: C:\Users\IH068592\Desktop\Drawings\WIP\MUN\Sheets\Y2-C11.dwg Last Saved: September 5, 2023, by IH068592 Plotted: September 5, 2023

THE LOCATION OF UTILITIES IS APPROXIMATE ONLY, AND THE EXACT LOCATION SHOULD BE DETERMINED BY CONSULTING THE MUNICIPAL AUTHORITIES AND UTILITY COMPANIES CONCERNED. THE CONTRACTOR SHALL PROVE THE LOCATION OF UTILITIES AND SHALL BE RESPONSIBLE FOR ADEQUATE PROTECTION FROM DAMAGE DURING CONSTRUCTION.



CONSULTANT

SEAL

| No. | DATE | REVISIONS | BY |
|-----|----------|---------------------------------|----|
| 1 | SEP 2023 | NOTE ADDED AS PER TRCA COMMENTS | IH |
| 0 | AUG 2023 | ISSUED FOR CONCEPTUAL DESIGN | CA |



Regional Municipality of York

| | |
|---------|-----------|
| DATE | AUG. 2023 |
| DESIGN | IH |
| DRAWN | CA |
| CHECKED | PP/DB |

YORK REGION SEWAGE WORKS PROJECT
 MARKHAM COLLECTOR TWINNING (Y2)
 CONCEPTUAL DRAWINGS
 PLAN AND PROFILE
 STA 7+000 TO STA 7+700

| | |
|-----------------|-------------------------|
| SCALE | H = 1:1000 V = 1:100 |
| DWG. NO. | Y2-C11 |
| CLIENT REF. NO. | 75320-EI18031 |
| SHEET NO. | 11 |

SCALE CHECK

UTILITY LEGEND

- EXISTING SANITARY
- EXISTING STORM
- EXISTING WATER
- EXISTING GAS
- EXISTING TELECOM
- PROPOSED SANITARY ALIGNMENT
- PROPOSED ALIGNMENT CHAINAGE

NOTE: EXISTING UTILITY LOCATIONS ARE APPROXIMATE AND OBTAINED FROM AS-BUILT AND GIS DATA.

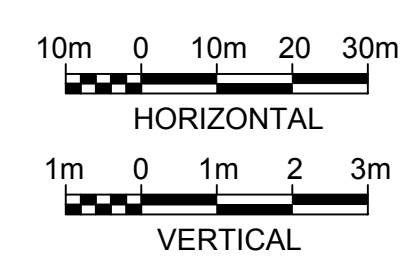
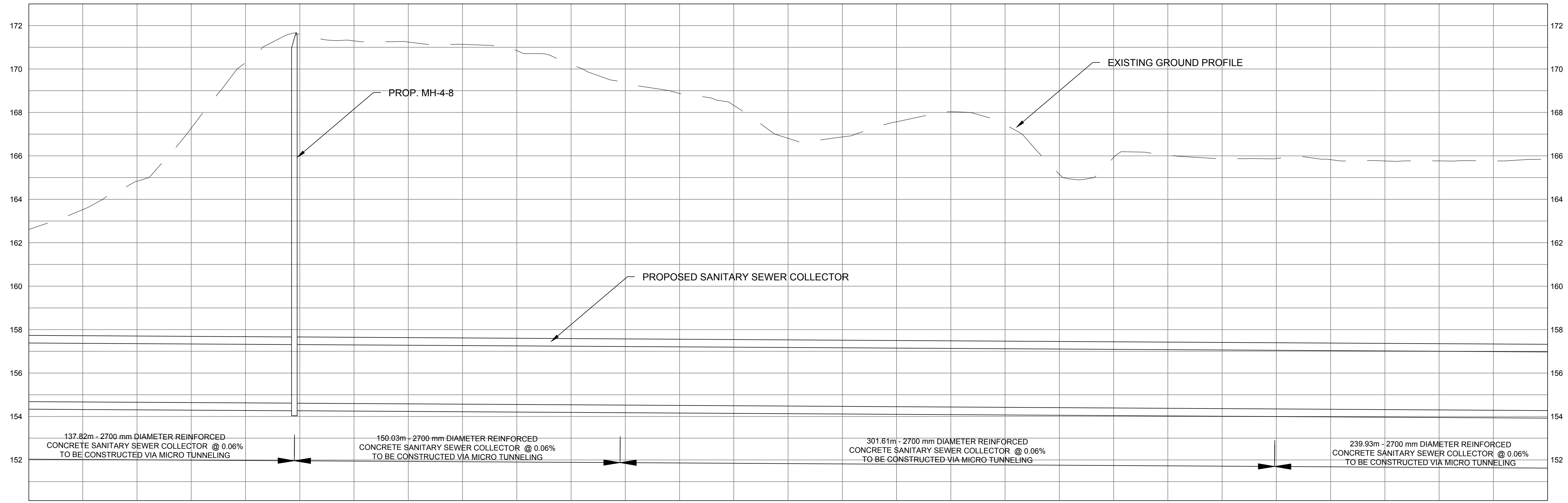
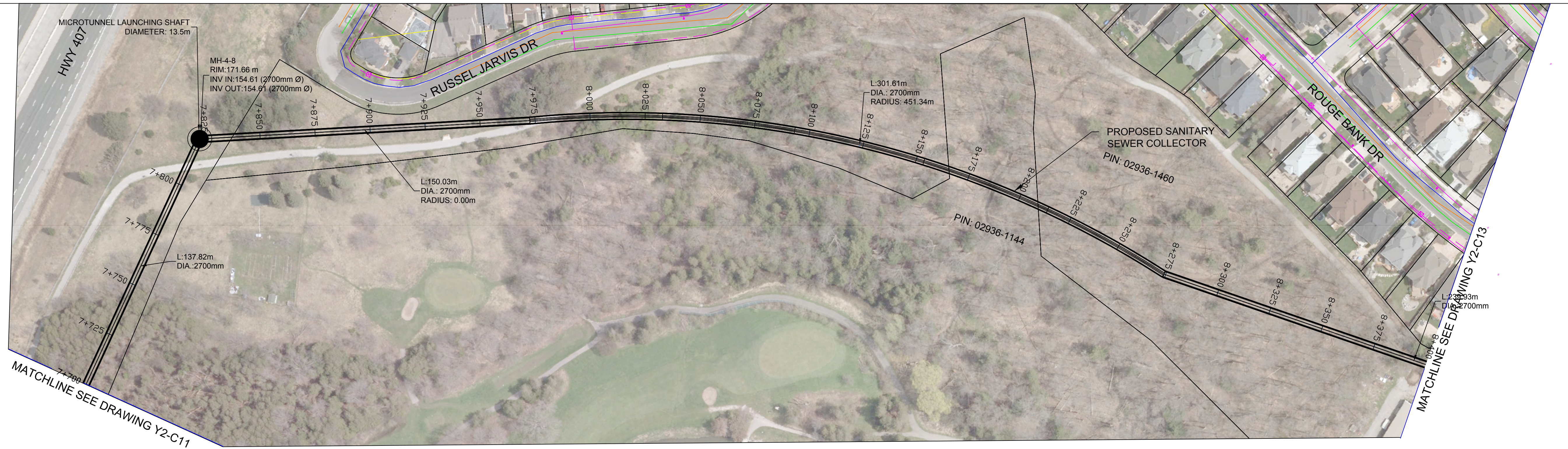
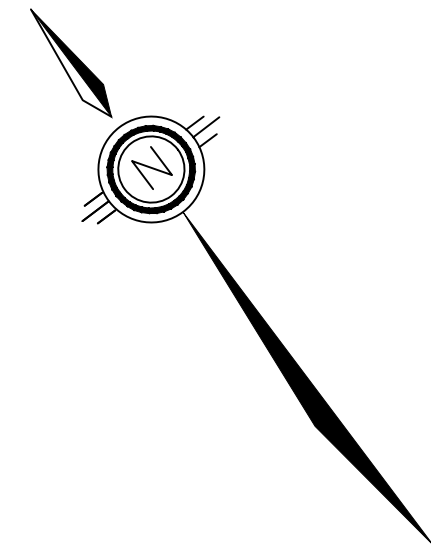

| STRUCTURE NAME | GROUND EL. (m) | PIPE INVERT LEVEL (m) | PIPE LINE CHAINAGE (m) |
|----------------|----------------|-----------------------|------------------------|
| | | | 7+700.00 |
| | | | 7+725.00 |
| | | | 7+750.00 |
| | | | 7+775.00 |
| | | | 7+800.00 |
| | | | 7+825.00 |
| | | | 7+850.00 |
| | | | 7+875.00 |
| | | | 7+900.00 |
| | | | 7+925.00 |
| | | | 7+950.00 |
| | | | 7+975.00 |
| | | | 8+000.00 |
| | | | 8+025.00 |
| | | | 8+050.00 |
| | | | 8+075.00 |
| | | | 8+100.00 |
| | | | 8+125.00 |
| | | | 8+150.00 |
| | | | 8+175.00 |
| | | | 8+200.00 |
| | | | 8+225.00 |
| | | | 8+250.00 |
| | | | 8+275.00 |
| | | | 8+300.00 |
| | | | 8+325.00 |
| | | | 8+350.00 |
| | | | 8+375.00 |
| | | | 8+400.00 |

File Location: C:\Users\IH068592\OneDrive - Jacobs\Y2-MarkhamCollector\Y2-Conceptual Drawings\WIP\MUN\Sheets\Y2-C12.dwg Last Saved: August 25, 2023, by IH068592 Plotter: August 25, 2023

THE LOCATION OF UTILITIES IS APPROXIMATE ONLY, AND THE EXACT LOCATION SHOULD BE DETERMINED BY CONSULTING THE MUNICIPAL AUTHORITIES AND UTILITY COMPANIES CONCERNED. THE CONTRACTOR SHALL PROVE THE LOCATION OF UTILITIES AND SHALL BE RESPONSIBLE FOR ADEQUATE PROTECTION FROM DAMAGE DURING CONSTRUCTION.



| No. | DATE | REVISIONS | BY |
|-----|----------|------------------------------|----|
| 0 | AUG 2023 | ISSUED FOR CONCEPTUAL DESIGN | CA |



| | | |
|-------------------|--------------------------------------------------------------------------------------------------------------------------------------------------------------------|----------------------------------|
| DATE AUG. 2023 | YORK REGION SEWAGE WORKS PROJECT MARKHAM COLLECTOR TWINNING (Y2) CONCEPTUAL DRAWINGS PLAN AND PROFILE STA 7+700 TO STA 8+400 | SCALE H = 1:1000 V = 1:100 |
| DESIGN IH | | DWG. NO. Y2-C12 |
| DRAWN CA | | CLIENT REF. NO. 75320-EI18031 |
| CHECKED PP/DB | | SHEET NO. 12 |

UTILITY LEGEND

- EXISTING SANITARY
- EXISTING STORM
- EXISTING WATER
- EXISTING GAS
- EXISTING TELECOM
- = PROPOSED SANITARY ALIGNMENT
- = PROPOSED ALIGNMENT CHAINAGE

NOTE: EXISTING UTILITY LOCATIONS ARE APPROXIMATE AND OBTAINED FROM AS-BUILT AND GIS DATA.

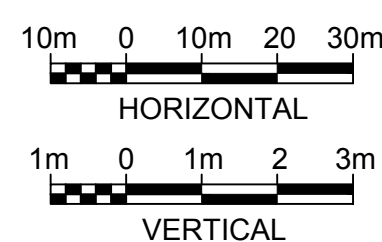
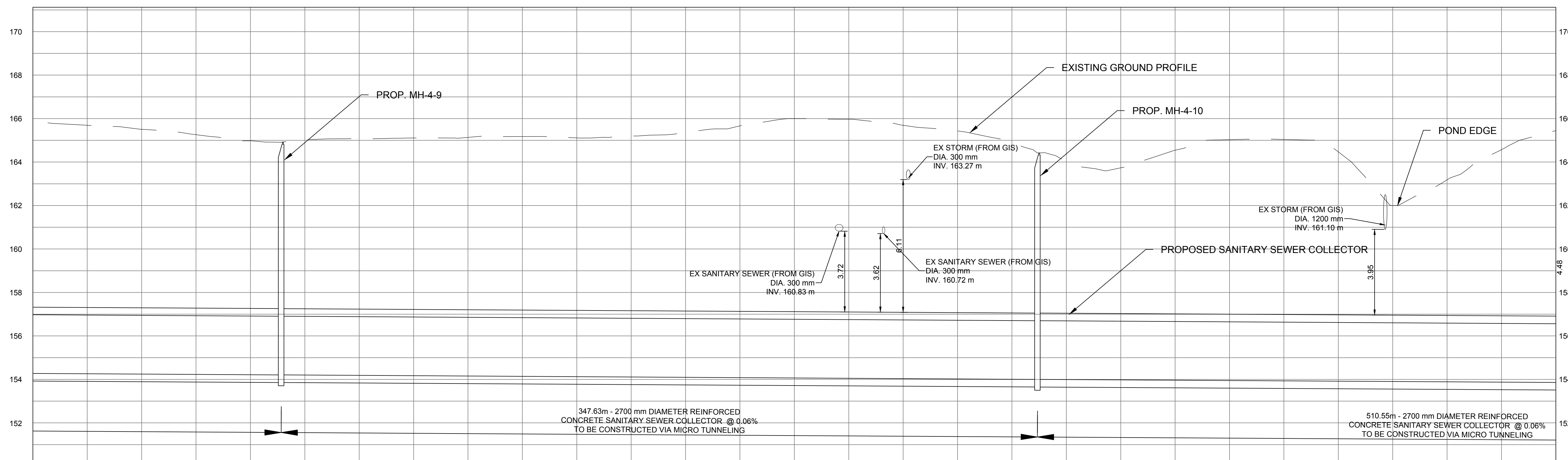
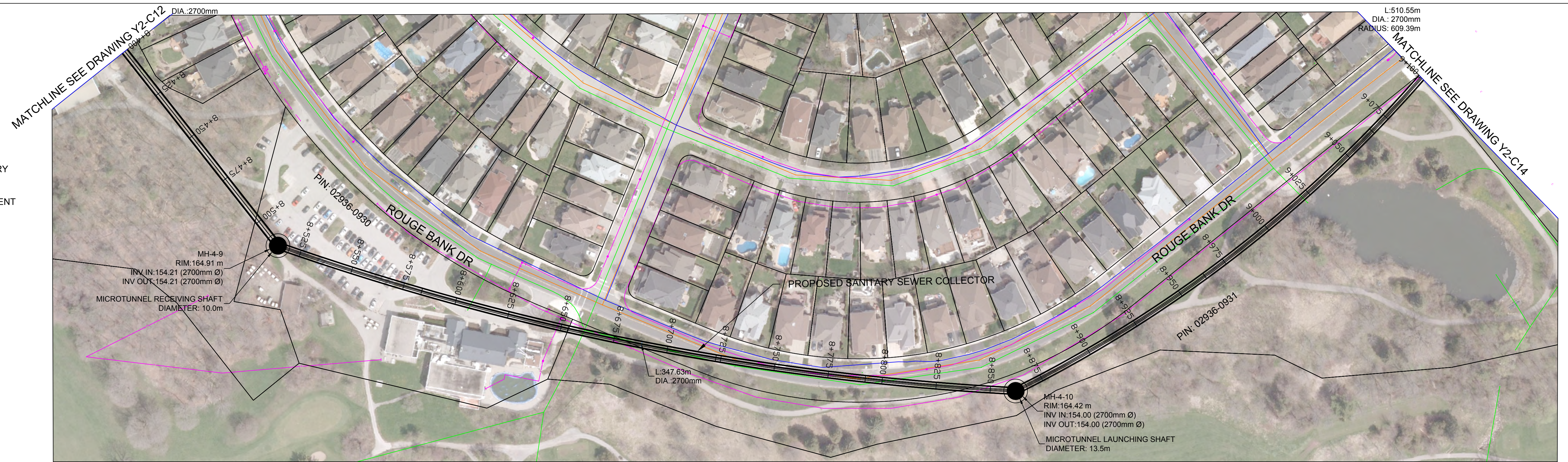
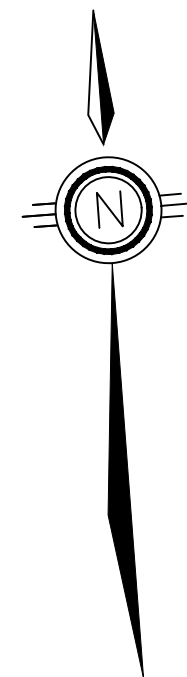

| STRUCTURE NAME | GROUND EL. (m) | PIPE INVERT LEVEL (m) | PIPE LINE CHAINAGE (m) |
|----------------|----------------|-----------------------|------------------------|
| | | | 8+400.00 |
| | | | 8+425.00 |
| | | | 8+450.00 |
| | | | 8+475.00 |
| | | | 8+500.00 |
| | | | 8+525.00 |
| | | | 8+550.00 |
| | | | 8+575.00 |
| | | | 8+600.00 |
| | | | 8+625.00 |
| | | | 8+650.00 |
| | | | 8+675.00 |
| | | | 8+700.00 |
| | | | 8+725.00 |
| | | | 8+750.00 |
| | | | 8+775.00 |
| | | | 8+800.00 |
| | | | 8+825.00 |
| | | | 8+850.00 |
| | | | 8+875.00 |
| | | | 8+900.00 |
| | | | 8+925.00 |
| | | | 8+950.00 |
| | | | 8+975.00 |
| | | | 9+100.00 |

File Location: C:\Users\jhd86892\OneDrive - Jacobs\Y2-MarkhamCollector\Y2-Conceptual Drawings\WIP\MUN\Sheets\Y2-C13.dwg Last Saved: August 9, 2023, by jhd86892 Plotted: August 25, 2023

THE LOCATION OF UTILITIES IS APPROXIMATE ONLY, AND THE EXACT LOCATION SHOULD BE DETERMINED BY CONSULTING THE MUNICIPAL AUTHORITIES AND UTILITY COMPANIES CONCERNED. THE CONTRACTOR SHALL PROVE THE LOCATION OF UTILITIES AND SHALL BE RESPONSIBLE FOR ADEQUATE PROTECTION FROM DAMAGE DURING CONSTRUCTION.



| No. | DATE | REVISIONS | BY |
|-----|----------|------------------------------|----|
| 0 | AUG 2023 | ISSUED FOR CONCEPTUAL DESIGN | CA |



Regional Municipality of York

| | |
|---------|-----------|
| DATE | AUG. 2023 |
| DESIGN | IH |
| DRAWN | CA |
| CHECKED | PP/DB |

**YORK REGION SEWAGE WORKS PROJECT
MARKHAM COLLECTOR TWINNING (Y2)**

CONCEPTUAL DRAWINGS

PLAN AND PROFILE

STA 8+400 TO STA 9+100

| | |
|-----------------|-------------------------|
| SCALE | H = 1:1000 V = 1:100 |
| DWG. NO. | Y2-C13 |
| CLIENT REF. NO. | 75320-EI18031 |
| SHEET NO. | 13 |

SCALE CHECK

UTILITY LEGEND

- EXISTING SANITARY
- EXISTING STORM
- EXISTING WATER
- EXISTING GAS
- EXISTING TELECOM
- = PROPOSED SANITARY ALIGNMENT
- = PROPOSED ALIGNMENT CHAINAGE

NOTE: EXISTING UTILITY LOCATIONS ARE APPROXIMATE AND OBTAINED FROM AS-BUILT AND GIS DATA.

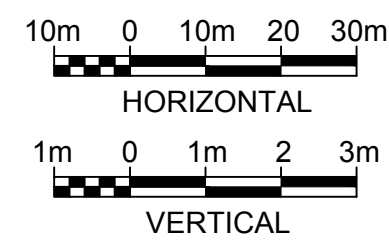
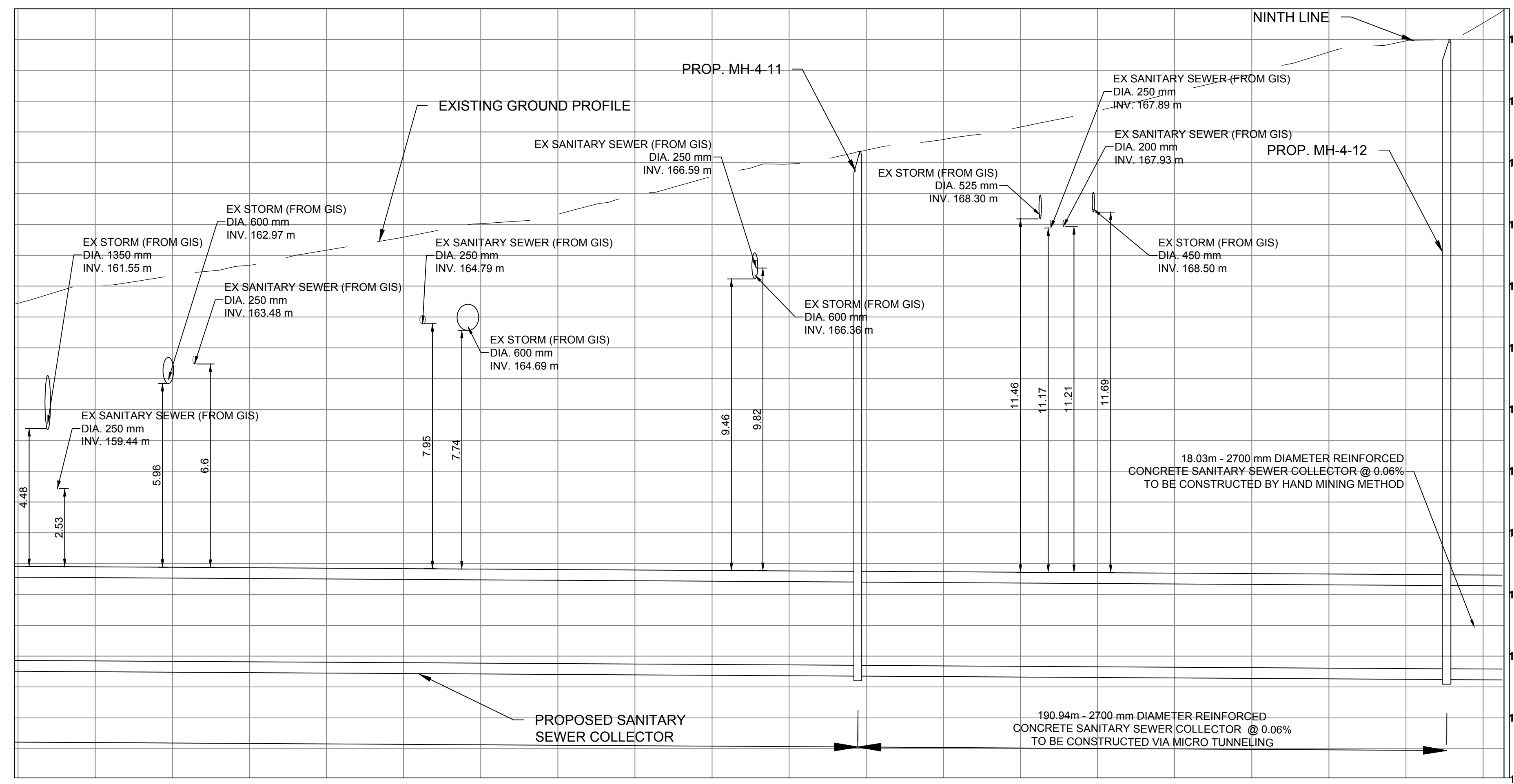
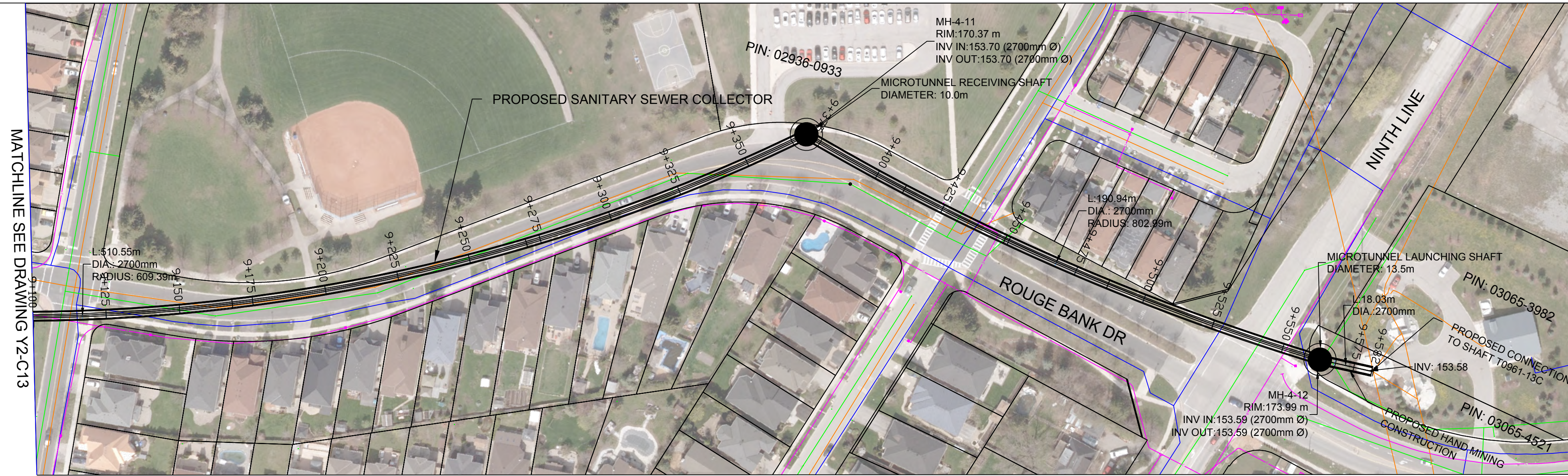
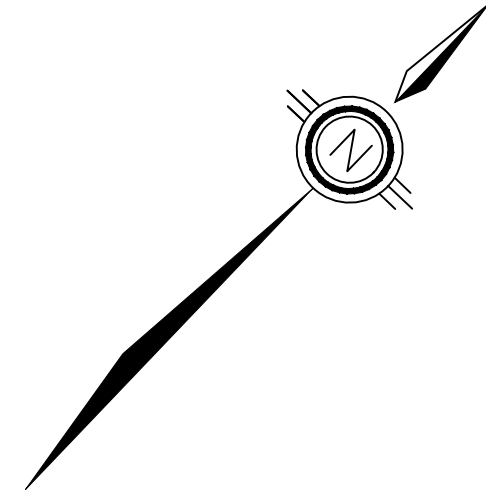

| | |
|------------------------|--|
| STRUCTURE NAME | |
| GROUND EL. (m) | |
| PIPE INVERT LEVEL (m) | |
| PIPE LINE CHAINAGE (m) | |

| | | | | | | | | | | | | | | | | | | | | | |
|----------|----------|----------|----------|----------|----------|----------|----------|----------|----------|----------|----------|----------|----------|----------|----------|----------|----------|----------|----------|----------|--|
| 9+100.00 | 9+125.00 | 9+150.00 | 9+175.00 | 9+200.00 | 9+225.00 | 9+250.00 | 9+275.00 | 9+300.00 | 9+325.00 | 9+350.00 | 9+375.00 | 9+400.00 | 9+425.00 | 9+450.00 | 9+475.00 | 9+500.00 | 9+525.00 | 9+550.00 | 9+575.00 | 9+600.00 | |
| | | | | | | | | | | | | | | | | | | | | | |
| | | | | | | | | | | | | | | | | | | | | | |
| | | | | | | | | | | | | | | | | | | | | | |

File Location: C:\Users\H068592\OneDrive - Jacobs\Y2-MarkhamCollector\Y2-Conceptual Drawings\WIP\MUN\Sheets\Y2-C14.dwg Last Saved: August 9, 2023, by H068592 Plotted: August 25, 2023

THE LOCATION OF UTILITIES IS APPROXIMATE ONLY, AND THE EXACT LOCATION SHOULD BE DETERMINED BY CONSULTING THE MUNICIPAL AUTHORITIES AND UTILITY COMPANIES CONCERNED. THE CONTRACTOR SHALL PROVE THE LOCATION OF UTILITIES AND SHALL BE RESPONSIBLE FOR ADEQUATE PROTECTION FROM DAMAGE DURING CONSTRUCTION.



CONSULTANT

SEAL

| No. | DATE | REVISIONS | BY |
|-----|----------|------------------------------|----|
| 0 | AUG 2023 | ISSUED FOR CONCEPTUAL DESIGN | CA |



Regional Municipality of York

| | |
|---------|-----------|
| DATE | AUG. 2023 |
| DESIGN | IH |
| DRAWN | CA |
| CHECKED | PP/DB |

YORK REGION SEWAGE WORKS PROJECT
 MARKHAM COLLECTOR TWINNING (Y2)
 CONCEPTUAL DRAWINGS
 PLAN AND PROFILE
 STA 9+100 TO STA 9+600

| | |
|-----------------|-------------------------|
| SCALE | H = 1:1000 V = 1:100 |
| DWG. NO. | Y2-C14 |
| CLIENT REF. NO. | 75320-EI18031 |
| SHEET NO. | 14 |

SCALE CHECK